

SAXONIA

Edelstahltechnik und -handels GmbH

Salzburger Strasse 38 - 40

01279 Dresden

Tel.: 0351 2542831

Fax.: 0351 2542833

e-Mail: service@saxonia-edelstahl.de

www.saxonia-edelstahl.de



Rohrverschraubungen DIN 2353

Inhalt

	Seite
Gerade Verschraubung	3
Winkelverschraubung	3
T - Verschraubung	4
Kreuzverschraubung	4
Gerade Einschraubverschraubung	5 - 8
Winkel- Einschraubverschraubung	9 - 11
T - Einschraubverschraubung	12 - 13
L - Einschraubverschraubung	14 - 15
Gerade Aufschraubverschraubung	16
Gerade Anschweißverschraubung	17
Gerade Anschweißverschraubung mit Schweißnippel	17
Schottverschraubungen	18 - 19
Reduzierschraubungen	20 - 22
Gewinde Reduzierstutzen mit Whitworth-Rohrgewinde	23
Gerade - Einschraubverschraubung mit Dichtkegel und O-Ring	23
Einschraubstutzen mit Schaft	24
Gerade - Einschraubverschraubung mit Dichtkegel und O-Ring	24 - 25
Einstellbare Winkelverschraubung mit Dichtkegel und O-Ring	25
Einstellbare T - Verschraubung mit Dichtkegel und O-Ring	26
Einstellbare L - Verschraubung mit Dichtkegel und O-Ring	26
Gerades Verbindungsstück mit Dichtkegel und O-Ring	27
Winkel-Schwenkverschraubung	27 - 28
T - Schwenkverschraubung	28 - 29
Einstellbare Manometeranschlußstutzen	29
Manometeranschlußverschraubungen	30
Rückschlagventil	30 - 31
Meßanschluß	32
Meßventile	32
Verschlussverschraubung	33
Verschlussstopfen	34
Schweißnippel	35
Überwurfmutter	36
Schneidring	36
Gegenmutter	37
Verstärkungshülse	37
Dichtringen	38 - 39

Gerade Verschraubung

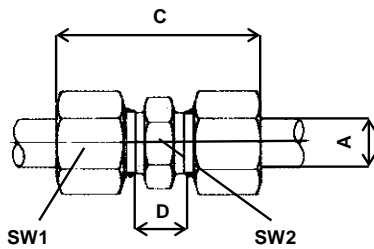

Reihe	PN	A	C	D	SW1	SW2	
LL	100	4	31	12	10	9	
		6	32	9	12	11	
		8	35	12	14	12	
L	250	6	39	10	14	12	
		8	40	11	17	14	
		10	42	13	19	17	
		12	43	14	22	19	
		15	46	16	27	24	
	160	18	48	16	32	27	
		22	52	20	36	32	
	100	28	54	21	41	41	
		35	63	20	50	46	
		42	66	21	60	55	
	S	630	6	45	16	17	14
			8	47	18	19	17
10			49	17	22	19	
12			41	19	24	22	
14			57	22	27	24	
400		16	57	21	30	27	
		20	66	23	36	32	
		25	74	26	46	41	
250		30	80	27	50	46	
		38	90	29	60	55	

Winkelverschraubung

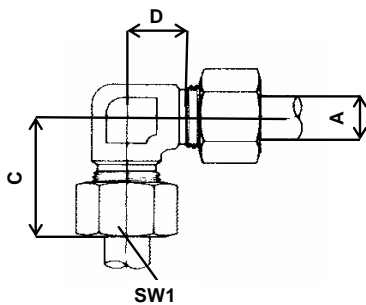

Reihe	PN	A	C	D	SW1	
LL	100	4	21	11,0	10	
		6	21	9,5	12	
		8	23	11,5	14	
L	250	6	27	12,0	14	
		8	29	14,0	17	
		10	30	15,0	19	
		12	32	17,0	22	
		15	36	21,0	27	
	160	18	40	23,5	32	
		22	44	27,5	36	
	100	28	47	30,5	41	
		35	56	34,5	50	
		42	63	40,0	60	
	S	630	6	31	16,0	17
			8	32	17,0	19
10			34	17,5	22	
12			38	21,5	24	
14			40	22,0	27	
400		16	43	24,5	30	
		20	48	26,5	36	
		25	54	30,0	46	
250		30	62	35,5	50	
		38	72	41,0	60	

T - Verschraubung

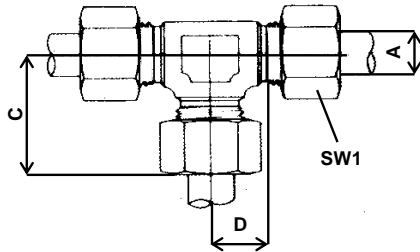

Reihe	PN	A	C	D	SW1
LL	100	4	21	11,0	10
		6	21	9,5	12
		8	35	11,5	14
L	250	6	27	12,0	14
		8	29	14,0	17
		10	30	15,0	19
		12	32	17,0	22
	15	36	21,0	27	
	160	18	40	23,5	32
		22	44	27,5	36
	100	28	47	30,5	41
		35	56	34,5	50
		42	63	40,0	60
S	630	6	31	16,0	17
		8	32	17,0	19
		10	34	17,5	22
		12	38	21,5	24
		14	40	22,0	27
	400	16	43	24,5	30
		20	48	26,5	36
		25	54	30,0	46
	250	30	62	35,5	50
		38	72	41,0	60

Kreuzverschraubung

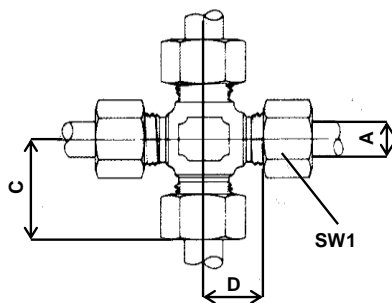

Reihe	PN	A	C	D	SW1
LL	100	4	21	11,0	10
		6	21	9,5	12
		8	35	11,5	14
L	250	6	27	12,0	14
		8	29	14,0	17
		10	30	15,0	19
		12	32	17,0	22
	15	36	21,0	27	
	160	18	40	23,5	32
		22	44	27,5	36
	100	28	47	30,5	41
		35	56	34,5	50
		42	63	40,0	60
S	630	6	31	16,0	17
		8	32	17,0	19
		10	34	17,5	22
		12	38	21,5	24
		14	40	22,0	27
	400	16	43	24,5	30
		20	48	26,5	36
		25	54	30,0	46
	250	30	62	35,5	50
		38	72	41,0	60

Gerade Einschraubverschraubung mit zylindrischem Whitworth-Rohrgewinde

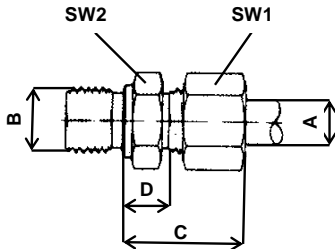

Reihe	PN	A	B	C	D	SW1	SW2
L	250	6	G 1/8 A	23,0	8,5	14	14
		6	G 1/4 A	24,5	10,0	14	19
		6	G 3/8 A	26,0	11,5	14	22
		6	G 1/2 A	26,5	12,0	14	27
		8	G 1/8 A	23,5	8,5	17	14
		8	G 1/4 A	25,0	10,0	17	19
		8	G 3/8 A	26,0	11,5	17	22
		8	G 1/2 A	26,5	12,0	17	27
		10	G 1/8 A	25,5	11,5	19	14
		10	G 1/4 A	26,0	12,0	19	19
		10	G 3/8 A	27,5	12,5	19	22
		10	G 1/2 A	29,0	14,0	19	27
		12	G 1/8 A	25,5	10,5	22	19
		12	G 1/4 A	26,0	11,0	22	19
		12	G 3/8 A	27,5	12,5	22	22
		12	G 1/2 A	28,0	13,0	22	27
		15	G 1/4 A	28,0	13,0	27	24
		15	G 3/8 A	28,5	13,5	27	24
		15	G 1/2 A	29,0	14,0	27	27
		15	G 3/4 A	30,0	15,0	27	32
	160	18	G 3/8 A	31,0	14,5	32	27
		18	G 1/2 A	31,0	14,5	32	27
		18	G 3/4 A	31,0	14,5	32	32
		22	G 1/2 A	33,0	16,5	36	32
		22	G 3/4 A	33,0	16,5	36	32
		22	G 1 A	34,0	17,5	36	41
	100	28	G 1/2 A	33,0	17,5	41	41
		28	G 3/4 A	33,0	17,5	41	41
		28	G 1 A	34,0	17,5	41	41
		28	G 1 1/4 A	35,0	18,5	41	50
		35	G 1/2 A	37,0	17,5	50	46
		35	G 3/4 A	38,0	17,5	50	46
		35	G 1 A	38,0	17,5	50	46
		35	G 1 1/4 A	39,0	17,5	50	50
		35	G 1 1/2 A	41,0	19,5	50	55
		42	G 1 A	39,0	16,0	60	55
		42	G 1 1/4 A	40,0	19,0	60	55
		42	G 1 1/2 A	42,0	19,0	60	55

Gerade Einschraubverschraubung mit zylindrischem Whitworth-Rohrgewinde

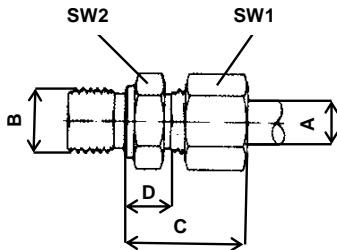

Reihe	PN	A	B	C	D	SW1	SW2
S	630	6	G 1/8 A	26,0	12,5	17	14
		6	G 1/4 A	28,0	13,0	17	19
		6	G 3/8 A	30,0	15,5	17	22
		6	G 1/2 A	33,0	18,0	17	27
		6	G 3/4 A	35,0	20,0	17	32
		8	G 1/4 A	30,0	15,0	19	19
		8	G 3/8 A	30,5	15,5	19	22
		8	G 1/2 A	33,0	18,0	19	27
		10	G 1/4 A	30,5	14,5	22	19
		10	G 3/8 A	31,0	15,0	22	22
		10	G 1/2 A	33,5	17,5	22	27
		12	G 1/4 A	33,0	16,5	24	22
		12	G 3/8 A	33,0	17,0	24	22
		12	G 1/2 A	33,5	17,5	24	27
		12	G 3/4 A	34,0	17,5	24	32
		14	G 1/4 A	34,0	16,0	27	24
		14	G 3/8 A	37,0	18,5	27	24
		14	G 1/2 A	37,0	19,0	27	27
		14	G 3/4 A	39,0	21,0	27	32
		14	G 1 A	41,0	23,0	27	41
	400	16	G 3/8 A	35,0	18,0	30	27
		16	G 1/2 A	37,0	18,5	30	27
		16	G 3/4 A	39,0	20,5	30	32
		20	G 1/2 A	42,0	20,5	36	32
		20	G 3/4 A	42,0	20,5	36	32
		20	G 1 A	44,0	22,5	36	41
		20	G 1 1/4 A	44,0	22,5	36	50
		20	G 1 1/2 A	47,0	25,5	36	55
		25	G 1/2 A	47,0	23,0	46	41
		25	G 3/4 A	45,0	23,0	46	41
		25	G 1 A	47,0	23,0	46	41
		25	G 1 1/4 A	47,0	23,0	46	50
	250	30	G 1 A	50,0	23,5	50	46
		30	G 1 1/4 A	50,0	23,5	50	50
		30	G 1 1/2 A	53,0	26,5	50	55
		38	G 1 1/4 A	54,0	23,0	60	55
		38	G 1 1/2 A	57,0	26,0	60	55

Gerade Einschraubverschraubung mit zylindrischem metrischem Gewinde

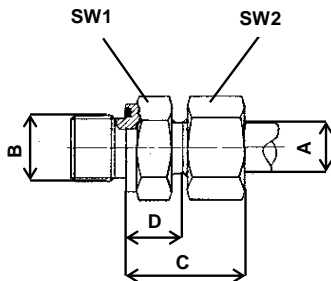

Reihe	PN	A	B	C	D	SW1	SW2
L	250	6	M 10x1	23,0	8,5	14	14
		8	M 12x1,5	25,0	10,0	17	17
		10	M 12x1,5	26,0	11,0	19	17
		10	M 14x1,5	26,0	11,0	19	19
		10	M 16x1,5	27,0	12,5	19	22
		12	M 16x1,5	27,5	12,5	22	22
	160	18	M 22x1,5	31,0	14,5	32	27
		22	M 26x1,5	33,0	16,5	36	32
		100	28	M 33x2	34,0	17,5	41
	35		M 42x2	39,0	17,5	50	50
	42		M 48x2	42,0	19,0	60	55
	S	630	6	M 12x1,5	28,0	13,0	17
6			M 14x1,5	28,0	13,0	17	19
8			M 14x1,5	30,0	15,0	19	19
10			M 16x1,5	31,0	15,0	22	22
12			M 14x1,5	33,0	16,5	24	22
12			M 18x1,5	33,0	17,0	24	24
400		14	M 20x1,5	37,0	19,0	27	27
		16	M 22x1,5	37,0	18,5	30	27
		20	M 27x2	42,0	20,5	36	32
250		25	M 33x2	47,0	23,0	46	41
		30	M 42x2	50,0	23,5	50	50
		38	M 48x2	57,0	26,0	60	55

Gerade Einschraubverschraubung mit kegligem Whitworth-Rohrgewinde

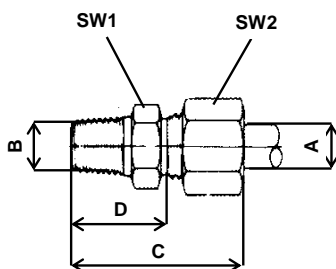

Reihe	PN	A	B	C	D	SW1	SW2
L	100	4	R 1/8 keg.	25,5	16,0	10	11
		6	R 1/8 keg.	26,0	14,5	12	11
		8	R 1/8 keg.	28,0	16,5	14	12
		10	R 1/4 keg.	36,0	21,0	19	17
LL	250	6	R 1/8 keg.	30,5	16,0	14	12
		6	R 1/4 keg.	34,5	20,0	14	14
		6	R 3/8 keg.	33,5	19,0	14	19
		6	R 1/2 keg.	35,5	21,0	14	22
		8	R 1/4 keg.	35,0	20,0	17	14
		8	R 3/8 keg.	34,5	20,0	17	19
		8	R 1/2 keg.	36,5	22,0	17	22
		10	R 1/4 keg.	36,0	21,0	19	17
		10	R 3/8 keg.	36,0	21,0	19	17
		10	R 1/2 keg.	38,5	23,0	19	22
		12	R 3/8 keg.	37,0	22,0	22	19
		12	R 1/2 keg.	39,0	24,5	22	22
		15	R 1/2 keg.	40,0	25,0	27	24
		160	18	R 1/2 keg.	42,0	25,5	32

Gerade Einschraubverschraubung mit kegligem metrischem Gewinde

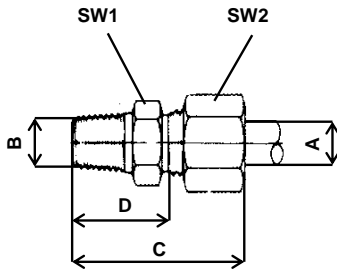

Reihe	PN	A	B	C	D	SW1	SW2	
LL	100	4	M 8x1 keg.	25,5	16,0	10	10	
		6	M 10x1 keg.	26,0	14,5	12	11	
		8	M 10x1 keg.	28,0	16,5	14	12	
L	250	6	M 10x1 keg.	30,5	16,0	14	14	
		6	M 12x1,5 keg.	34,5	20,0	14	14	
		8	M 12x1,5 keg.	35,0	20,0	17	14	
		8	M 14x1,5 keg.	35,0	20,0	17	17	
		10	M 14x1,5 keg.	36,0	21,0	19	17	
		10	M 16x1,5 keg.	36,0	21,0	19	17	
		12	M 16x1,5 keg.	37,0	22,0	22	19	
		12	M 18x1,5 keg.	39,0	22,0	22	19	
		15	M 18x1,5 keg.	40,0	23,0	27	24	
		160	18	M 22x1,5 keg.	42,0	25,5	32	27

Gerade Einschraubverschraubung mit NPT Gewinde

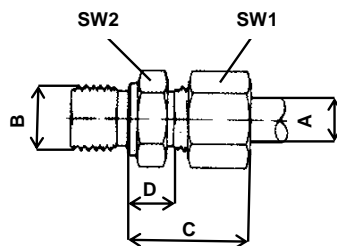

Reihe	PN	A	B	C	D	SW1	SW2
LL	100	4	1/8 NPT	28,0	18,0	10	11
		6	1/8 NPT	28,0	16,5	12	11
		8	1/8 NPT	30,0	18,5	14	12
L	250	6	1/8 NPT	31,5	17,0	14	12
		6	1/4 NPT	37,5	23,0	14	17
		6	3/8 NPT	39,0	24,0	14	19
		6	1/2 NPT	43,5	29,0	14	22
		8	1/8 NPT	33,0	18,0	17	14
		8	1/4 NPT	38,0	23,0	17	17
		8	3/8 NPT	39,0	24,0	17	19
		8	1/2 NPT	44,0	29,0	17	22
		10	1/8 NPT	34,0	19,0	19	17
		10	1/4 NPT	39,0	24,0	19	17
		10	3/8 NPT	40,0	25,0	19	19
		10	1/2 NPT	45,0	30,0	19	22
		10	3/4 NPT	46,0	21,0	19	27
		12	1/8 NPT	35,0	20,0	22	19
		12	1/4 NPT	40,0	25,0	22	19
	12	3/8 NPT	40,0	25,0	22	19	
	12	1/2 NPT	45,0	30,0	22	22	
	12	3/4 NPT	46,0	31,0	22	27	
	15	3/8 NPT	41,0	26,0	27	24	
	15	1/2 NPT	46,0	31,0	27	24	
	15	3/4 NPT	46,0	32,0	27	27	
	15	1 NPT	52,0	38,0	27	36	
	160	18	3/8 NPT	43,5	26,5	32	27
		18	1/2 NPT	48,0	31,5	32	27
		18	3/4 NPT	48,0	31,5	32	27
		18	1 NPT	54,0	37,5	32	36
		22	3/8 NPT	50,0	28,5	36	32
22		1/2 NPT	45,0	33,5	36	32	
22		3/4 NPT	50,0	33,5	36	32	
100	28	3/4 NPT	51,0	34,5	41	41	
	28	1 NPT	56,0	39,5	41	41	
	28	1 1/4 NPT	58,0	41,5	41	46	
	35	1 NPT	61,0	39,5	50	46	
	35	1 1/4 NPT	62,0	40,5	50	46	
	42	1 1/4 NPT	65,0	42,0	60	55	
42	1 1/2 NPT	65,0	42,0	60	55		

Winkel- Einschraubverschraubung mit zylindrischem Whitworth-Rohrgewinde

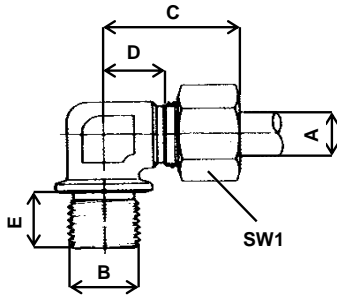

Reihe	PN	A	B	C	D	E	SW1
L	160	22	G 3/4 A	44	27,5	26	36
	100	28	G 1 A	47	30,5	30	41
		35	G 1 1/4 A	56	34,5	34	50
S	400	42	G 1 1/2 A	63	40,0	39	60
		20	G 3/4 A	48	26,5	26	36
	250	25	G 1 A	54	30,0	30	46
		30	G 1 1/4 A	62	35,5	34	50
		38	G 1 1/2 A	72	41,0	39	60

Winkel- Einschraubverschraubung mit zylindrischem metrischem Gewinde

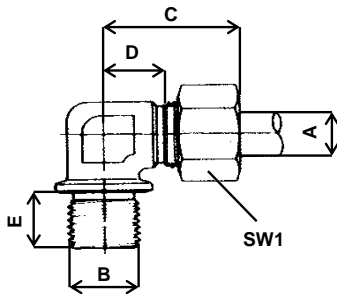

Reihe	PN	A	B	C	D	E	SW1
L	160	22	M 26x1,5	44	27,5	26	36
	100	28	M 33x2	47	30,5	30	41
		35	M 42x2	56	34,5	34	50
S	400	42	M 48x2	63	40,0	39	60
		20	M 27x2	48	26,5	26	36
	250	25	M 33x2	54	30,0	30	46
		30	M 42x2	62	35,5	34	50
		38	M 48x2	72	41,0	39	60

Winkel- Einschraubverschraubung mit kegligem Whitworth-Rohrgewinde

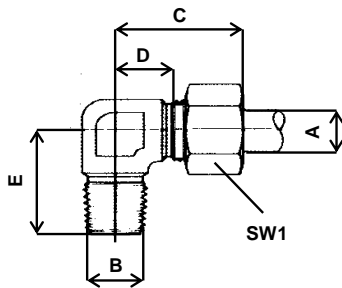

Reihe	PN	A	B	C	D	E	SW1
L	100	4	R 1/8 keg.	21,0	11,0	17	10
		6	R 1/8 keg.	21,0	9,5	17	12
		8	R 1/8 keg.	23,0	11,5	20	14
LL	250	6	R 1/8 keg.	26,5	12,0	20	14
		6	R 1/4 keg.	26,5	12,0	24	14
		8	R 1/8 keg.	28,5	14,0	26	17
		8	R 1/4 keg.	28,5	14,0	26	17
		8	R 3/8 keg.	29,5	15,0	27	17
		8	R 1/2 keg.	31,5	16,0	30	17
		10	R 1/4 keg.	29,5	15,0	27	19
		10	R 3/8 keg.	29,5	15,0	28	19
		10	R 1/2 keg.	29,5	15,0	30	19
		12	R 1/4 keg.	32,0	17,0	28	22
		12	R 3/8 keg.	32,0	17,0	28	22
		12	R 1/2 keg.	36,0	21,0	32	22
		15	R 3/8 keg.	36,0	21,0	28	27
		15	R 1/2 keg.	36,0	21,0	34	27
			160	18	R 1/2 keg.	40,0	25,0
S	630	6	R 1/4 keg.	31,0	16,0	26	17
		6	R 3/8 keg.	31,0	16,0	28	17
		6	R 1/2 keg.	31,0	16,0	30	17
		8	R 1/4 keg.	32,0	17,0	27	19
		8	R 3/8 keg.	32,0	17,0	27	19
		8	R 1/2 keg.	32,0	17,0	30	19
		10	R 1/4 keg.	34,0	17,5	27	22
		10	R 3/8 keg.	34,0	17,5	28	22
		10	R 1/2 keg.	34,0	17,5	31	22
		12	R 3/8 keg.	38,0	21,5	28	24
		12	R 1/2 keg.	38,0	21,5	32	24
		14	R 3/8 keg.	40,0	22,0	31	27
14	R 1/2 keg.	40,0	22,0	32	27		
	400	16	R 1/2 keg.	43,0	24,5	32	30

Winkel- Einschraubverschraubung mit kegligem metrischem Gewinde

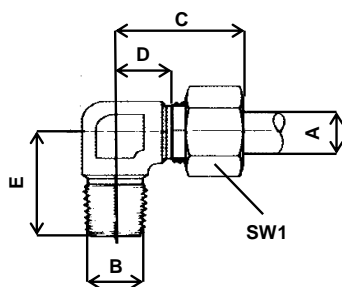

Reihe	PN	A	B	C	D	E	SW1
LL	100	4	M 8x1 keg.	21	11,0	17	10
		6	M 10x1 keg.	21	9,5	17	12
		8	M 10x1 keg.	23	11,5	20	14
L	250	6	M 10x1 keg.	27	12,0	20	14
		8	M 12x1,5 keg.	29	14,0	26	17
		10	M 14x1,5 keg.	30	15,0	27	19
		12	M 16x1,5 keg.	32	17,0	28	22
		15	M 18x1,5 keg.	36	21,0	32	27
	160	18	M 22x1,5 keg.	40	23,5	36	32
S	630	6	M 12x1,5 keg.	31	16,0	26	17
		8	M 14x1,5 keg.	32	17,0	27	19
		10	M 16x1,5 keg.	34	17,5	28	22
		12	M 18x1,5 keg.	38	21,5	28	24
		14	M 20x1,5 keg.	40	22,0	32	27
	400	16	M 22x1,5 keg.	43	24,5	32	30

Winkel- Einschraubverschraubung mit NPT Gewinde

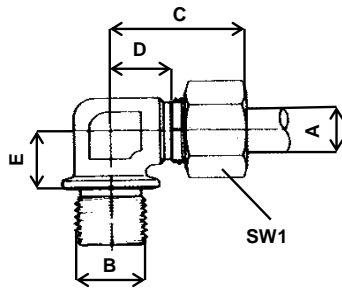

Reihe	PN	A	B	C	D	E	SW1
LL	100	4	1/8 NPT	21	11,0	17	10
		6	1/8 NPT	21	9,5	17	12
		8	1/8 NPT	23	11,0	20	14
L	250	6	1/8 NPT	27	12,0	30	14
		6	1/4 NPT	27	12,0	25	14
		6	3/8 NPT	27	12,0	28	14
		8	1/8 NPT	29	14,0	24	17
		8	1/4 NPT	29	14,0	26	17
		8	1/2 NPT	29	14,0	34	17
		10	1/4 NPT	30	15,0	27	19
		10	3/8 NPT	32	17,0	28	19
		10	1/2 NPT	30	15,0	34	19
	160	12	1/4 NPT	32	17,0	28	22
		12	3/8 NPT	32	17,0	28	22
		12	1/2 NPT	32	17,0	34	22
		15	1/2 NPT	36	21,0	34	27
		18	1/2 NPT	40	23,5	36	32
		22	3/4 NPT	44	27,5	42	36
100	28	1 NPT	47	30,5	48	41	
	35	1 1/4 NPT	56	34,5	54	50	
	42	1 1/2 NPT	63	40,0	61	60	
S	630	6	1/4 NPT	31	16,0	26	17
		6	3/8 NPT	31	16,0	28	17
		6	1/2 NPT	31	16,0	33	17
		8	1/4 NPT	32	17,0	27	19
		8	3/8 NPT	32	17,0	28	19
		8	1/2 NPT	32	17,0	33	19
		10	1/4 NPT	34	17,5	27	22
		10	3/8 NPT	34	17,5	28	22
		12	1/4 NPT	38	21,5	27	24
		12	3/8 NPT	38	21,5	28	24
		12	1/2 NPT	38	21,5	33	24
		14	3/8 NPT	40	22,0	28	27
	14	1/2 NPT	40	22,0	34	27	
	400	16	1/2 NPT	43	24,5	36	30
		20	3/4 NPT	48	26,5	42	36
		25	1 NPT	54	30,0	48	46
	250	30	1 1/4 NPT	62	35,5	54	50
		38	1 1/2 NPT	72	41,0	61	60

T - Einschraubverschraubung mit zylindrischem Whitworth-Rohrgewinde

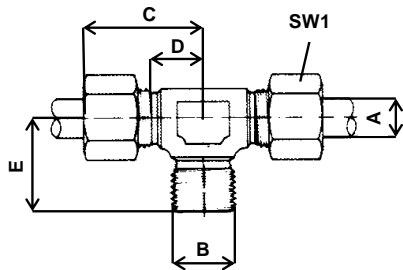

Reihe	PN	A	B	C	D	E	SW1
L	160	22	G 3/4 A	44	27,5	42	36
	100	28	G 1 A	47	30,5	48	41
		35	G 1 1/4 A	56	34,5	54	50
S	400	42	G 1 1/2 A	63	40,0	61	60
		20	G 3/4 A	48	26,5	42	36
	250	G 1 A	54	30,0	48	46	
S	250	30	G 1 1/4 A	62	35,5	54	50
		38	G 1 1/2 A	72	41,0	61	60

T - Einschraubverschraubung mit zylindrischem metrischem Gewinde

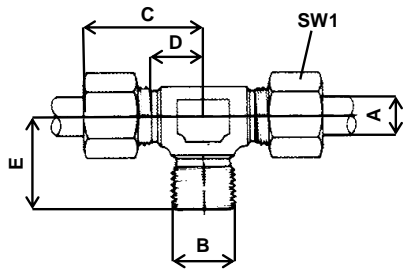

Reihe	PN	A	B	C	D	E	SW1
L	160	22	M 26x1,5	44	27,5	42	36
	100	28	M 33x2	47	30,5	48	41
		35	M 42x2	56	34,5	54	50
S	400	42	M 48x2	63	40,0	61	60
		20	M 27x2	48	26,5	42	36
	250	M 33x2	54	30,0	48	46	
S	250	30	M 42x2	62	35,5	54	50
		38	M 48x2	72	41,0	61	60

T - Einschraubverschraubung mit kegligem Whitworth-Rohrgewinde

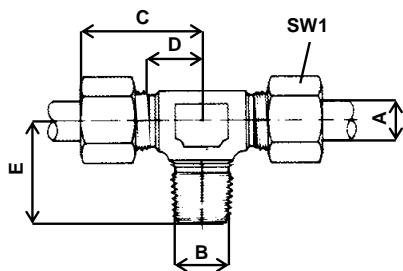

Reihe	PN	A	B	C	D	E	SW1	
L	100	4	R 1/8 keg.	21	11,0	17	10	
		6	R 1/8 keg.	21	9,5	17	12	
		8	R 1/8 keg.	23	11,5	20	14	
LL	250	6	R 1/8 keg.	27	12,0	20	14	
		8	R 1/4 keg.	29	14,0	26	17	
		10	R 1/4 keg.	30	15,0	27	19	
		12	R 3/8 keg.	32	17,0	28	22	
		15	R 1/2 keg.	36	21,0	34	27	
S	160	18	R 1/2 keg.	40	23,5	36	32	
		630	6	R 1/4 keg.	31	16,0	26	17
			8	R 1/4 keg.	32	17,0	27	19
	10		R 3/8 keg.	34	17,5	28	22	
	12		R 3/8 keg.	38	21,5	28	24	
	14		R 1/2 keg.	40	22,0	32	27	
	400	16	R 1/2 keg.	43	24,5	32	30	

T - Einschraubverschraubung mit kegligem metrischem Gewinde

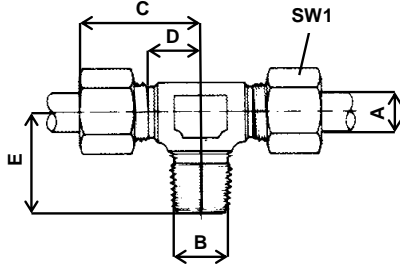

Reihe	PN	A	B	C	D	E	SW1
LL	100	4	M 8x1 keg.	21	11,0	17	10
		6	M 10x1 keg.	21	9,5	17	12
		8	M 10x1 keg.	23	11,5	20	14
L	250	6	M 10x1 keg.	27	12,0	20	14
		8	M 12x1,5 keg.	29	14,0	26	17
		10	M 14x1,5 keg.	30	15,0	27	19
		12	M 16x1,5 keg.	32	17,0	28	22
		15	M 18x1,5 keg.	36	21,0	32	27
	160	18	M 22x1,5 keg.	40	23,5	36	32
S	630	6	M 12x1,5 keg.	31	16,0	26	17
		8	M 14x1,5 keg.	32	17,0	27	19
		10	M 16x1,5 keg.	34	17,5	28	22
		12	M 18x1,5 keg.	38	21,5	28	24
		14	M 20x1,5 keg.	40	22,0	32	27
	400	16	M 22x1,5 keg.	43	24,5	32	30

T - Einschraubverschraubung mit NPT Gewinde

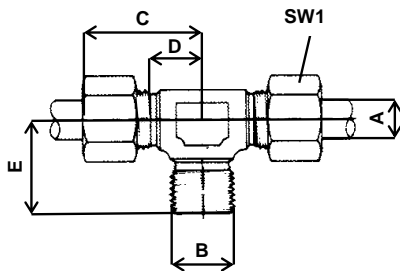

Reihe	PN	A	B	C	D	E	SW1
LL	100	4	1/8 NPT	21	11,0	17	10
		4	1/4 NPT	22	11,0	21	10
		6	1/8 NPT	21	9,5	17	12
		8	1/8 NPT	23	11,0	20	14
L	250	6	1/8 NPT	27	12,0	30	14
		8	1/4 NPT	29	14,0	26	17
		10	1/4 NPT	30	15,0	27	19
		12	3/8 NPT	32	17,0	28	22
		15	1/2 NPT	36	21,0	34	27
	160	18	1/2 NPT	40	23,5	36	32
		22	3/4 NPT	44	27,5	42	36
		28	1 NPT	47	30,5	48	41
100	35	1 1/4 NPT	56	34,5	54	50	
	42	1 1/2 NPT	63	40,0	61	60	
S	630	6	1/4 NPT	31	16,0	26	17
		8	1/4 NPT	32	17,0	27	19
		10	3/8 NPT	34	17,5	28	22
		12	3/8 NPT	38	21,5	28	24
		14	1/2 NPT	40	22,0	34	27
	400	16	1/2 NPT	43	24,5	36	30
		20	3/4 NPT	48	26,5	42	36
		25	1 NPT	54	30,0	48	46
		30	1 1/4 NPT	62	35,5	54	50
		38	1 1/2 NPT	72	41,0	61	60

L - Einschraubverschraubung mit zylindrischem Whitworth-Rohrgewinde

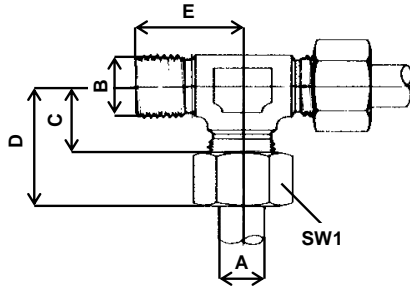

Reihe	PN	A	B	C	D	E	SW1
L	160	22	G 3/4 A	44	27,5	26	36
	100	28	G 1 A	47	30,5	30	41
		35	G 1 1/4 A	56	34,5	34	50
S	400	42	G 1 1/2 A	63	40,0	39	60
		20	G 3/4 A	48	26,5	26	36
	250	G 1 A	54	30,0	30	46	
S	250	30	G 1 1/4 A	62	35,5	34	50
		38	G 1 1/2 A	72	41,0	39	60

L - Einschraubverschraubung mit zylindrischem metrischem Gewinde

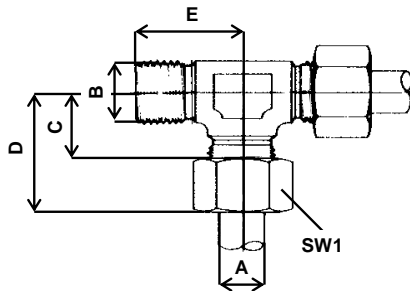

Reihe	PN	A	B	C	D	E	SW1
L	160	22	M 26x1,5	44	27,5	26	36
	100	28	M 33x2	47	30,5	30	41
		35	M 42x2	56	34,5	34	50
S	400	42	M 48x2	63	40,0	39	60
		20	M 27x2	48	26,5	26	36
	250	M 33x2	54	30,0	30	46	
S	250	30	M 42x2	62	35,5	34	50
		38	M 48x2	72	41,0	39	60

L - Einschraubverschraubung mit kegligem Whitworth-Rohrgewinde

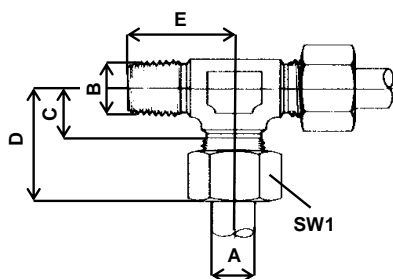

Reihe	PN	A	B	C	D	E	SW1
L	100	4	R 1/8 keg.	21	11,0	17	10
		6	R 1/8 keg.	21	9,5	17	12
		8	R 1/8 keg.	23	11,5	20	14
LL	250	6	R 1/8 keg.	27	12,0	20	14
		8	R 1/4 keg.	29	14,0	26	17
		10	R 1/4 keg.	30	15,0	27	19
		12	R 3/8 keg.	32	17,0	28	22
		15	R 1/2 keg.	36	21,0	34	27
S	160	18	R 1/2 keg.	40	23,5	36	32
		630	6	R 1/4 keg.	31	16,0	26
8	R 1/4 keg.		32	17,0	27	19	
10	R 3/8 keg.		34	17,5	28	22	
12	R 3/8 keg.		38	21,5	28	24	
14	R 1/2 keg.		40	22,0	32	27	
400	16	R 1/2 keg.	43	24,5	32	30	

L - Einschraubverschraubung mit kegligem metrischem Gewinde

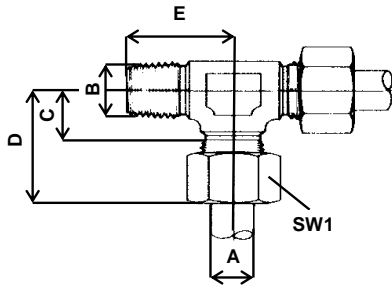

Reihe	PN	A	B	C	D	E	SW1
LL	100	4	M 8x1 keg.	21	11,0	17	10
		6	M 10x1 keg.	21	9,5	17	12
		8	M 10x1 keg.	23	11,5	20	14
L	250	6	M 10x1 keg.	27	12,0	20	14
		8	M 12x1,5 keg.	29	14,0	26	17
		10	M 14x1,5 keg.	30	15,0	27	19
		12	M 16x1,5 keg.	32	17,0	28	22
		15	M 18x1,5 keg.	36	21,0	32	27
	160	18	M 22x1,5 keg.	40	23,5	36	32
S	630	6	M 12x1,5 keg.	31	16,0	26	17
		8	M 14x1,5 keg.	32	17,0	27	19
		10	M 16x1,5 keg.	34	17,5	28	22
		12	M 18x1,5 keg.	38	21,5	28	24
		14	M 20x1,5 keg.	40	22,0	32	27
	400	16	M 22x1,5 keg.	43	24,5	32	30

L - Einschraubverschraubung mit NPT Gewinde

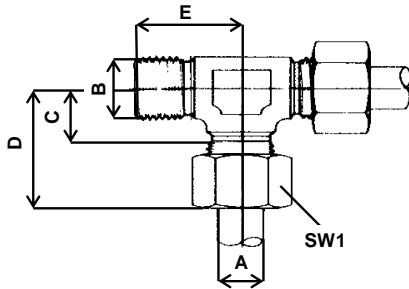

Reihe	PN	A	B	C	D	E	SW1
LL	100	4	1/8 NPT	21	11,0	17	10
		6	1/8 NPT	21	9,5	17	12
		8	1/8 NPT	23	11,0	20	14
L	250	6	1/8 NPT	27	12,0	30	14
		8	1/4 NPT	29	14,0	26	17
		10	1/4 NPT	30	15,0	27	19
		12	3/8 NPT	32	17,0	28	22
		15	1/2 NPT	36	21,0	34	27
	160	18	1/2 NPT	40	23,5	36	32
		22	3/4 NPT	44	27,5	42	36
	100	28	1 NPT	47	30,5	48	41
		35	1 1/4 NPT	56	34,5	54	50
		42	1 1/2 NPT	63	40,0	61	60
S	630	6	1/4 NPT	31	16,0	26	17
		8	1/4 NPT	32	17,0	27	19
		10	3/8 NPT	34	17,5	28	22
		12	3/8 NPT	38	21,5	28	24
		14	1/2 NPT	40	22,0	34	27
	400	16	1/2 NPT	43	24,5	36	30
		20	3/4 NPT	48	26,5	42	36
		25	1 NPT	54	30,0	48	46
	250	30	1 1/4 NPT	62	35,5	54	50
		38	1 1/2 NPT	72	41,0	61	60

Gerade Aufschraubverschraubung mit Whitworth-Rohrgewinde

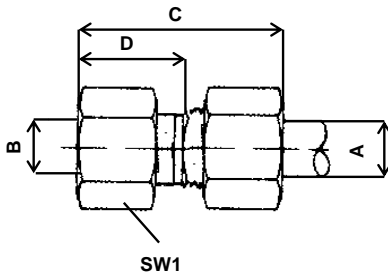

Reihe	PN	A	B	C	D	SW1
L	250	6	G 1/8	34	19,0	14
		6	G 1/4	39	24,0	14
		8	G 1/4	39	24,0	17
		10	G 1/4	40	25,0	19
		12	G 3/8	41	26,0	22
		12	G 1/2	46	29,0	22
		15	G 3/8	42	27,0	27
		15	G 1/2	46	31,0	27
	160	18	G 3/8	44	27,5	32
		18	G 1/2	47	30,5	32
		22	G 3/4	52	35,5	36
	100	28	G 1	55	38,0	41
		35	G 1 1/4	63	41,0	50
		42	G 1 1/2	65	42,5	60
	S	630	6	G 1/8	36	21,0
6			G 1/4	41	26,0	17
8			G 1/4	41	26,0	19
10			G 3/8	43	26,5	22
12			G 1/4	45	27,0	24
12			G 3/8	43	26,5	24
12			G 1/2	47	29,5	24
14			G 1/2	50	32,0	27
400		16	G 1/2	50	31,5	30
		20	G 3/8	49	27,5	36
		20	G 1/2	42	30,5	36
		20	G 3/4	56	34,5	36
		25	G 1	62	37,5	46
250		30	G 1 1/4	69	42,0	50
		38	G 1 1/2	74	43,5	60

Gerade Aufschraubverschraubung mit metrischem Gewinde

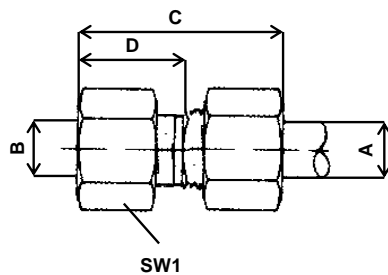

Reihe	PN	A	B	C	D	SW1	
L	250	6	M 10x1	34	19,5	14	
		8	M 12x1,5	39	24,0	17	
		10	M 14x1,5	40	25,0	19	
		12	M 16x1,5	41	26,0	22	
		12	M 18x1,5	43	28,0	22	
		15	M 20x1,5	43	28,0	27	
		15	M 18x1,5	43	28,0	27	
		160	18	M 22x1,5	46	29,5	32
	22		M 26x1,5	51	34,5	36	
	100	28	M 33x2	54	37,5	41	
		42	M 48x2	65	42,0	60	
	S	630	6	M 12x1,5	41	26,0	17
			8	M 14x1,5	41	26,0	19
			10	M 16x1,5	43	26,5	22
			12	M 18x1,5	44	27,5	24
12			M 20x1,5	46	29,5	24	
14			M 20x1,5	49	31,0	27	
400		16	M 22x1,5	49	30,5	30	
		20	M 27x2	56	34,5	36	
		25	M 33x2	61	37,0	46	
250		30	M 42x2	68	41,5	50	
		38	M 48x2	74	43,0	60	

Gerade Anschweißverschraubung

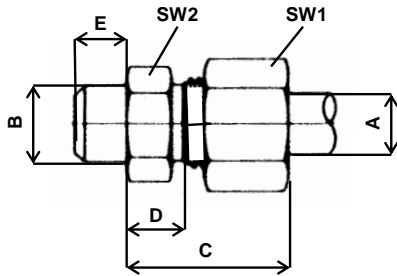

Reihe	PN	A	B	C	D	E	SW1	SW2
L	250	6	10	29	14,0	7	14	12
		8	12	31	16,0	8	17	14
		10	14	33	18,0	8	19	17
		12	16	33	18,0	8	22	19
		15	19	37	22,0	10	27	22
L	160	18	22	40	23,5	10	32	27
		22	27	45	28,5	12	36	32
L	100	28	32	47	30,5	12	41	41
		35	40	54	32,5	14	50	46
		42	46	58	35,0	16	60	55
S	630	6	11	34	19,0	7	17	14
		8	13	36	21,0	8	19	17
		10	15	39	22,5	8	22	19
		12	17	41	24,5	10	24	22
S	400	14	19	45	27,0	10	27	24
		16	21	45	26,5	10	30	27
		20	26	51	29,5	12	36	32
S	250	25	31	56	32,0	12	46	41
		30	36	62	35,5	14	50	46
		38	44	69	38,0	16	60	55

Gerade Anschweißverschraubung mit Schweißnippel

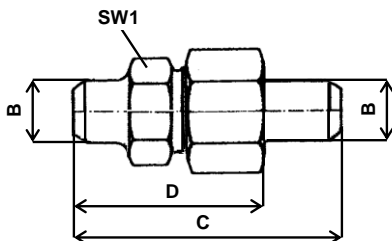

B	C	D	SW1
10	56	40	19
12	62	45	22
16	72	49	27
20	81	57	32
25	92	64	41
30	97	67	46
38	109	75	55

Gerade - Schottverschraubung

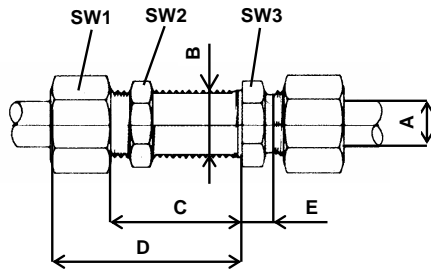

Reihe	PN	A	B	C	D	E	SW1	SW2	SW3	
L	250	6	M 12x1,5	27,0	42	7,0	17	17	14	
		8	M 14x1,5	27,0	42	8,0	19	19	17	
		10	M 16x1,5	28,0	43	10,0	22	22	19	
		12	M 18x1,5	29,0	44	10,0	24	24	22	
		15	M 22x1,5	31,0	46	12,0	30	27	27	
	160	18	M 26x1,5	32,5	49	13,5	36	32	32	
		22	M 30x2	34,5	51	16,5	41	36	36	
		100	28	M 33x2	35,5	52	18,5	46	41	41
	35		M 45x2	36,5	58	18,5	55	50	50	
	42		M 52x2	36,0	59	19,0	65	60	60	
	S	630	6	M 14x1,5	29,0	44	12,0	19	19	17
			8	M 16x1,5	29,0	44	13,0	22	22	19
10			M 18x1,5	29,5	46	14,5	24	24	22	
12			M 20x1,5	30,5	47	14,5	27	27	24	
14			M 22x1,5	32,0	50	17,0	30	30	27	
400		16	M 24x1,5	31,5	50	16,5	32	32	30	
		20	M 30x2	33,5	55	17,5	41	41	38	
		25	M 36x2	35,0	59	20,0	46	46	46	
250		30	M 42x2	35,5	64	21,5	50	50	50	
		38	M 52x2	37,0	68	22,0	65	65	60	

Winkel - Schottverschraubung

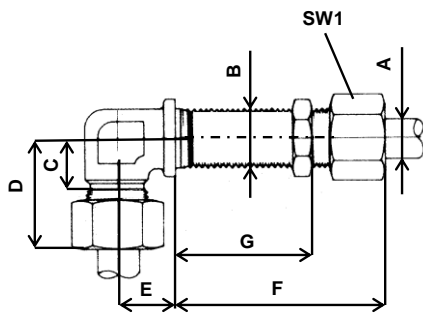

Reihe	PN	A	B	C	D	E	F	G	SW1	
L	250	6	M 12x1,5	12,0	27	14	42	27,0	17	
		8	M 14x1,5	14,0	29	17	42	27,0	19	
		10	M 16x1,5	15,0	30	18	43	28,0	22	
		12	M 18x1,5	17,0	32	20	44	29,0	24	
		15	M 22x1,5	21,0	36	23	46	31,0	30	
	160	18	M 26x1,5	23,5	40	24	49	32,5	36	
		22	M 30x2	27,5	44	30	51	34,5	41	
		100	28	M 33x2	30,5	47	34	52	35,5	46
	35		M 45x2	34,5	56	39	58	36,5	55	
	42		M 52x2	40,0	63	43	59	36,0	65	
	S	630	6	M 14x1,5	16,0	31	17	44	29,0	19
			8	M 16x1,5	17,0	32	18	44	29,0	22
10			M 18x1,5	17,5	34	20	46	29,5	24	
12			M 20x1,5	21,5	38	21	47	30,5	27	
14			M 22x1,5	22,0	40	23	50	32,0	30	
400		16	M 24x1,5	24,5	43	24	50	31,5	32	
		20	M 30x2	26,5	48	30	55	33,5	41	
		25	M 36x2	30,0	54	34	59	35,0	46	
250		30	M 42x2	35,5	62	39	64	37,5	50	
		38	M 52x2	41,0	72	43	68	37,0	65	

Einschweiß - Schottverschraubung

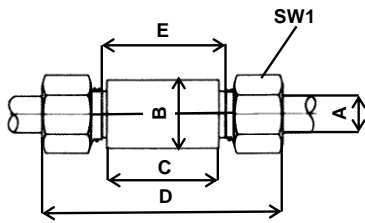

Reihe	PN	A	B	C	D	E	SW1
L	250	6	18	56	85	50	14
		8	20	56	85	50	17
		10	22	58	87	50	19
		12	25	58	87	50	22
		15	28	70	100	60	27
	160	18	32	69	101	60	32
		22	36	73	105	60	36
	100	28	40	73	106	60	41
		35	50	71	114	60	50
		42	60	70	115	60	60
S	630	6	20	60	89	50	17
		8	22	60	89	50	19
		10	25	59	91	50	22
		12	28	59	91	50	24
		14	30	72	107	60	27
	400	16	35	71	107	60	30
		20	38	71	114	60	36
		25	45	72	120	60	46
	250	30	50	73	126	60	50
		38	60	72	133	60	60

Kegel - Reduzierschraubung

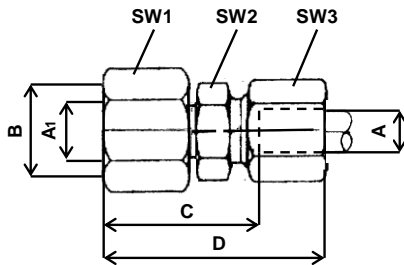

Reihe	PN	A	A1	B	C	D	SW1	SW2	SW3	
315		8	6	M 14x1,5	23,0	37,5	17	12	14	
		10	6	M 16x1,5	24,5	39,0	19	14	14	
		10	8	M 16x1,5	24,5	39,5	19	14	17	
		12	6	M 18x1,5	25,0	39,5	22	17	14	
		12	8	M 18x1,5	25,0	40,0	22	17	17	
		12	10	M 18x1,5	26,0	41,0	22	17	19	
		15	6	M 22x1,5	26,5	41,0	27	22	14	
		15	8	M 22x1,5	26,5	41,5	27	22	17	
		15	10	M 22x1,5	27,5	42,5	27	22	19	
		15	12	M 22x1,5	27,5	42,0	27	22	22	
		18	6	M 26x1,5	28,5	43,0	32	24	14	
		18	8	M 26x1,5	28,5	43,5	32	24	17	
		18	10	M 26x1,5	29,5	44,5	32	24	19	
		18	12	M 26x1,5	29,5	44,0	32	24	22	
		18	15	M 26x1,5	30,5	46,0	32	24	27	
	L	160	22	6	M 30x2	31,0	45,5	36	27	14
			22	8	M 30x2	31,0	46,0	36	27	17
			22	10	M 30x2	32,0	47,0	36	27	19
22			12	M 30x2	32,0	46,5	36	27	22	
22			15	M 30x2	33,0	48,5	36	27	27	
22			18	M 30x2	32,5	49,0	36	27	32	
28			6	M 36x2	31,0	45,5	46	36	14	
28			8	M 36x2	32,0	47,0	46	36	17	
28			10	M 36x2	33,0	48,0	46	36	19	
28			12	M 36x2	33,0	47,5	46	36	22	
28			15	M 36x2	34,0	49,5	46	36	27	
28			18	M 36x2	33,5	50,0	46	36	32	
35		6	M 45x2	36,0	50,5	50	46	14		
35		8	M 45x2	36,0	51,0	50	46	17		
35		10	M 45x2	37,0	52,0	50	46	19		
35		12	M 45x2	37,0	51,5	50	46	22		
35		15	M 45x2	38,0	53,5	50	46	27		
35		18	M 45x2	37,5	54,0	50	46	32		
35		22	M 45x2	39,5	56,0	50	46	36		
35		28	M 45x2	39,5	56,0	50	46	41		
42		6	M 52x2	38,0	52,5	60	50	14		
42		8	M 52x2	38,0	53,0	60	50	17		
42		10	M 52x2	39,0	54,0	60	50	19		
42		12	M 52x2	39,0	53,5	60	50	22		
42	15	M 52x2	40,0	53,5	60	50	27			
42	18	M 52x2	39,5	56,0	60	50	32			
42	22	M 52x2	41,5	58,0	60	50	36			
42	28	M 52x2	41,5	58,0	60	50	41			
42	35	M 52x2	40,0	61,5	60	50	50			

Kegel - Reduzierschraubung

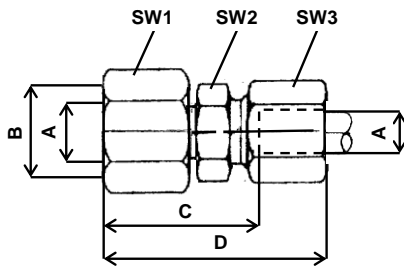

Reihe	PN	A	A1	B	C	D	SW1	SW2	SW3
S	630	8	6	M 14x1,5	28,0	43,0	19	14	17
		10	6	M 16x1,5	30,5	43,5	22	17	17
		10	8	M 16x1,5	30,5	45,5	22	17	19
		12	6	M 18x1,5	31,0	46,0	24	19	17
		12	8	M 18x1,5	31,0	46,0	24	19	19
		12	10	M 18x1,5	30,5	46,5	24	19	22
		14	6	M 22x1,5	33,5	48,5	27	22	17
		14	8	M 22x1,5	33,5	48,5	27	22	19
		14	10	M 22x1,5	33,0	49,0	27	22	22
		14	12	M 22x1,5	33,0	49,0	27	22	24
S	400	16	6	M 26x1,5	34,0	49,0	30	24	17
		16	8	M 26x1,5	34,0	49,0	30	24	19
		16	10	M 26x1,5	33,5	49,5	30	24	22
		16	12	M 26x1,5	33,5	49,5	30	24	24
		16	14	M 26x1,5	35,0	53,0	30	24	27
		20	6	M 30x2	38,5	53,5	36	27	17
		20	8	M 30x2	38,5	53,5	36	27	19
		20	10	M 30x2	38,0	54,0	36	27	22
		20	12	M 30x2	38,0	54,0	36	27	24
		20	14	M 30x2	39,5	57,5	36	27	27
		20	16	M 30x2	39,0	57,5	36	27	30
		25	6	M 36x2	42,0	57,0	46	36	17
		25	8	M 36x2	42,0	57,0	46	36	19
		25	10	M 36x2	41,5	57,5	46	36	22
		25	12	M 36x2	41,5	57,5	46	36	24
		25	14	M 36x2	43,0	61,0	46	36	27
		25	16	M 36x2	42,5	61,0	46	36	30
		25	20	M 36x2	42,5	64,0	46	36	36
		30	6	M 45x2	46,0	61,0	50	41	17
		30	8	M 45x2	46,0	61,0	50	41	19
		30	10	M 45x2	45,5	61,5	50	41	22
		30	12	M 45x2	45,5	61,5	50	41	24
		30	14	M 45x2	47,0	65,0	50	41	27
30	16	M 45x2	46,5	65,0	50	41	30		
30	20	M 45x2	46,5	68,0	50	41	36		
30	25	M 45x2	47,0	71,0	50	41	46		
S	315	38	6	M 52x2	49,5	64,5	60	50	17
		38	8	M 52x2	49,5	64,5	60	50	19
		38	10	M 52x2	49,0	65,0	60	50	22
		38	12	M 52x2	49,0	65,0	60	50	24
		38	14	M 52x2	50,5	68,5	60	50	27
		38	16	M 52x2	50,0	68,5	60	50	30
		38	20	M 52x2	50,0	71,5	60	50	36
		38	25	M 52x2	50,5	74,5	60	50	46
38	30	M 52x2	51,0	77,5	60	50	50		

Gerade Reduzierschraubung

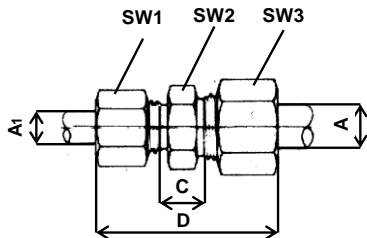

Reihe	PN	A	A1	C	D	SW1	SW2	SW3	
L	250	8	6	11,0	40,0	17	14	14	
		10	6	12,0	41,0	19	17	14	
		10	8	12,0	41,0	19	17	17	
		12	6	13,0	42,0	22	19	14	
		12	8	13,0	42,0	22	19	17	
		12	10	14,0	43,0	22	19	19	
		15	6	14,0	43,5	27	24	14	
		15	8	14,0	43,5	27	24	17	
		15	10	15,0	44,5	27	24	19	
		15	12	15,0	44,5	27	24	22	
	160	18	8	14,5	45,0	32	27	17	
		18	10	15,5	46,0	32	27	19	
		18	12	15,5	46,0	32	27	22	
		18	15	16,5	47,5	32	27	27	
		22	12	17,5	48,0	36	32	22	
		22	15	18,5	49,0	36	32	27	
		22	18	18,0	51,0	36	32	32	
		100	28	10	18,5	49,5	46	41	19
			28	15	19,5	51,0	46	41	27
			28	18	19,0	52,0	46	41	32
	28		22	21,0	54,0	46	41	36	
	35		28	21,0	59,0	50	46	41	
	42		28	22,5	61,5	60	55	41	
	42	35	21,5	66,5	60	55	50		
	S	630	8	6	18,0	47,0	19	17	17
			10	6	17,5	48,0	22	19	17
			10	8	17,5	48,0	22	19	19
12			6	19,5	50,0	24	22	17	
12			8	19,5	50,0	24	22	19	
12			10	19,0	51,0	24	22	22	
14			10	20,5	54,0	27	24	22	
14			12	20,5	54,0	27	24	24	
400		16	10	20,0	54,5	30	27	22	
		16	12	20,0	54,0	30	27	24	
		16	14	21,5	57,0	30	27	27	
		20	10	22,0	59,5	36	32	22	
		20	12	22,0	59,5	36	32	24	
		20	14	23,5	62,5	36	32	27	
		20	16	23,0	62,5	36	32	30	
		25	16	25,5	64,5	46	41	30	
		25	20	25,5	71,0	46	41	36	
		250	30	20	26,0	74,0	50	46	36
30			25	26,5	77,0	50	46	46	
38			30	29,5	87,0	60	55	50	

Gewinde Reduzierstutzen mit Whitworth-Rohrgewinde

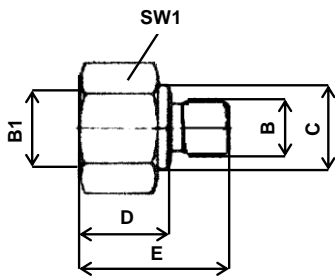

PN	B	B1	C	D	E	SW1
630	G 1/8 A	G 1/4	14	23	31	19
	G 1/8 A	G 3/8	14	24	32	24
	G 1/4 A	G 1/8	18	16	28	19
	G 1/4 A	G 3/8	18	24	36	24
	G 1/4 A	G 1/2	18	28	40	27
	G 1/4 A	G 3/4	18	31	43	36
	G 3/8 A	G 1/4	22	24	36	22
	G 3/8 A	G 1/2	22	29	41	27
400	G 3/8 A	G 3/4	22	32	44	36
630	G 1/2 A	G 3/8	26	22	36	27
400	G 1/2 A	G 3/4	26	32	46	36
	G 1/2 A	G 1	26	35	49	41
	G 1/2 A	G 1 1/4	26	39	53	55
	G 3/4 A	G 1/2	32	25	41	32
	G 3/4 A	G 1	32	35	51	41
	G 3/4 A	G 1 1/4	32	39	55	55
315	G 3/4 A	G 1 1/2	32	41	57	60
400	G 1 A	G 3/4	39	29	47	41
	G 1 A	G 1 1/4	39	39	57	55
315	G 1 A	G 1 1/2	39	41	59	60
400	G 1 1/4 A	G 1	49	32	52	50
315	G 1 1/4 A	G 1 1/2	49	40	60	60
	G 1 1/2 A	G 1 1/4	55	36	58	55

Gerade - Einschraubverschraubung mit Dichtkegel und O-Ring NPT - Gewinde

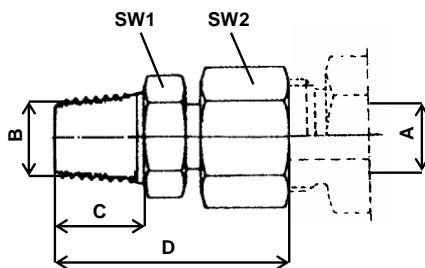

Reihe	PN	A	B	C	D	SW1	SW2		
L	315	6	1/8 NPT	10	29,0	11	17		
		8	1/4 NPT	15	35,0	14	17		
		10	1/4 NPT	15	36,0	14	19		
		12	3/8 NPT	15	38,0	19	22		
		15	1/2 NPT	20	43,0	22	27		
		18	1/2 NPT	20	46,0	27	32		
	160	22	3/4 NPT	20	47,0	27	36		
		28	1 NPT	15	53,0	36	46		
		35	1 1/4 NPT	26	57,0	46	50		
		42	1 1/2 NPT	26	58,0	50	60		
		S	630	6	1/4 NPT	15	35,5	14	17
				8	1/4 NPT	15	39,0	17	19
10	3/8 NPT			15	40,0	19	22		
12	3/8 NPT			15	42,0	19	24		
14	1/2 NPT		20	47,0	22	27			
400	16		1/2 NPT	20	47,0	24	30		
	20		3/4 NPT	20	53,0	27	36		
	25		1 NPT	25	60,0	36	46		
	30		1 1/4 NPT	26	62,0	46	50		
315	38		1 1/2 NPT	26	65,0	50	60		

Einschraubstutzen mit Schaft

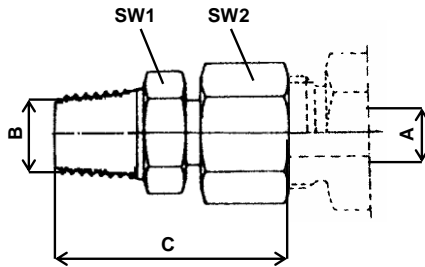

Reihe	PN	A	B	C	SW1	SW2
L	250	6	1/8 NPT	33,0	11	14
		8	1/4 NPT	40,0	14	17
		10	1/4 NPT	40,5	14	19
		12	1/4 NPT	40,5	14	22
		12	3/8 NPT	44,5	19	22
		12	1/2 NPT	45,5	22	22
		15	3/8 NPT	40,0	19	27
		15	1/2 NPT	48,0	22	27
	160	18	1/2 NPT	47,5	27	32
		22	3/4 NPT	49,0	27	36
	100	28	1 NPT	55,5	36	46
		35	1 1/4 NPT	62,5	46	50
42		1 1/2 NPT	65,0	50	60	
S	630	6	1/4 NPT	40,0	14	17
		8	1/4 NPT	40,0	14	19
		10	1/4 NPT	44,0	14	22
		10	3/8 NPT	44,0	19	22
		12	1/4 NPT	44,5	14	24
		12	3/8 NPT	44,5	19	24
		12	1/2 NPT	50,0	22	24
		14	1/2 NPT	53,5	22	27
	400	16	1/2 NPT	53,5	24	30
		20	3/4 NPT	58,0	27	36
		25	1 NPT	68,0	36	46
	315	30	1 1/4 NPT	73,5	46	50
		38	1 1/2 NPT	78,0	50	60

Gerade - Einschraubverschraubung mit Dichtkegel und O-Ring zyl. Whitworth-Rohrgewinde

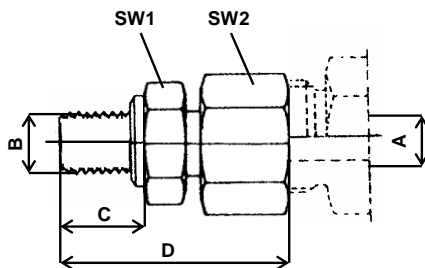

Reihe	PN	A	B	C	D	SW1	SW2	
L	315	6	G 1/8 A	8	28,5	14	17	
		8	G 1/4 A	12	34,0	19	17	
		10	G 1/4 A	12	35,0	19	19	
		12	G 1/4 A	12	36,5	19	22	
		12	G 3/8 A	12	37,0	22	22	
		15	G 1/2 A	14	40,0	27	27	
		18	G 1/2 A	14	42,5	27	32	
		160	22	G 3/4 A	16	46,0	32	36
	28		G 1 A	18	49,0	41	46	
	35		G 1 1/4 A	20	53,5	50	50	
	42		G 1 1/2 A	22	58,0	55	60	
	S	630	6	G 1/4 A	12	36,5	19	17
8			G 1/4 A	12	38,0	19	19	
10			G 3/8 A	12	41,0	22	22	
12			G 3/8 A	12	41,0	22	24	
12			G 1/2 A	12	41,0	22	24	
14			G 1/2 A	14	44,0	27	27	
400		16	G 1/2 A	14	44,0	27	30	
		20	G 3/4 A	16	52,0	32	36	
		25	G 1 A	18	56,0	41	46	
		30	G 1 1/4 A	20	60,0	50	50	
		315	38	G 1 1/2 A	22	63,0	55	60

Gerade - Einschraubverschraubung mit Dichtkegel und O-Ring zylindr. Metrischen-Gewind

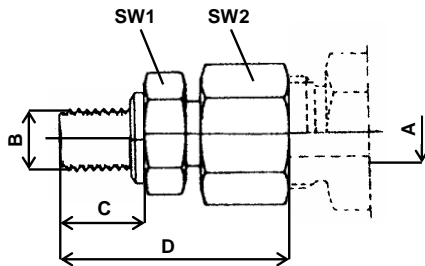

Reihe	PN	A	B	C	D	SW1	SW2
L	315	6	M 10x1	8	29,5	14	17
		8	M 12x1,5	12	34,0	19	17
		10	M 14x1,5	12	36,0	19	19
		12	M 16x1,5	12	36,5	19	22
		15	M 18x1,5	14	37,5	27	27
		18	M 22x1,5	14	42,5	27	32
L	160	22	M 26x1,5	16	46,0	32	36
		28	M 33x2	18	49,0	41	46
		35	M 42x2	20	54,5	50	50
		42	M 48x2	22	58,0	55	60
S	630	6	M 12x1,5	12	36,5	19	17
		8	M 14x1,5	12	38,0	19	19
		10	M 16x1,5	12	40,5	22	22
		12	M 18x1,5	12	41,5	22	24
		14	M 20x1,5	14	47,5	27	27
S	400	16	M 22x1,5	14	48,0	27	30
		20	M 27x1,5	16	52,0	32	36
		25	M 33x2	18	56,0	41	46
		30	M 42x2	20	60,5	50	50
S	315	38	M 48x2	22	62,5	55	60

Einstellbare Winkelverschraubung mit Dichtkegel und O-Ring

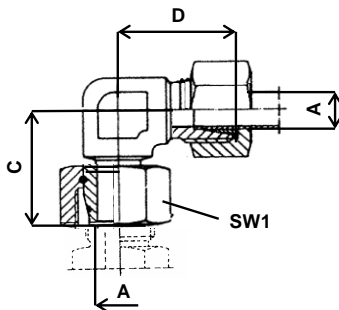

Reihe	PN	A	C	D	SW1
L	315	6	25,0	21	17
		8	26,0	21	17
		10	27,5	22	19
		12	28,5	24	22
		15	31,5	28	27
		18	34,0	31	32
L	160	22	37,0	35	36
		28	40,5	38	46
		35	48,5	45	50
		42	53,0	51	60
S	630	6	26,0	23	17
		8	26,5	24	19
		10	29,0	25	22
		12	29,5	29	24
		14	33,0	30	27
S	400	16	33,0	33	30
		20	41,5	37	36
		25	45,5	42	46
		30	49,5	49	50
S	315	38	55,0	57	60

Einstellbare T - Verschraubung mit Dichtkegel und O-Ring

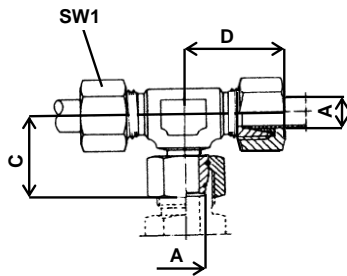

Reihe	PN	A	C	D	SW1
L	315	6	25,0	21	17
		8	26,0	21	17
		10	27,5	22	19
		12	28,5	24	22
		15	31,5	28	27
		18	34,0	31	32
	160	22	37,0	35	36
		28	40,5	38	46
		35	48,5	45	50
		42	53,0	51	60
S	630	6	26,0	23	17
		8	26,5	24	19
		10	29,0	25	22
		12	29,5	29	24
	400	14	33,0	30	27
		16	33,0	33	30
		20	41,5	37	36
		25	45,5	42	46
	315	30	49,5	49	50
		38	55,0	57	60

Einstellbare L - Verschraubung mit Dichtkegel und O-Ring

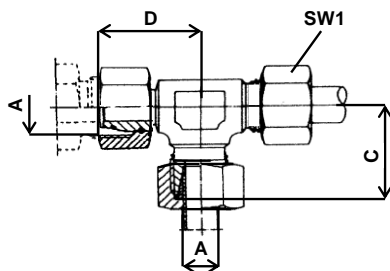

Reihe	PN	A	C	D	SW1
L	315	6	25,0	21	17
		8	26,0	21	17
		10	27,5	22	19
		12	28,5	24	22
		15	31,5	28	27
		18	34,0	31	32
	160	22	37,0	35	36
		28	40,5	38	46
		35	48,5	45	50
		42	53,0	51	60
S	630	6	26,0	23	17
		8	26,5	24	19
		10	29,0	25	22
		12	29,5	29	24
	400	14	33,0	30	27
		16	33,0	33	30
		20	41,5	37	36
		25	45,5	42	46
	315	30	49,5	49	50
		38	55,0	57	60

Gerades Verbindungsstück mit Dichtkegel und O-Ring

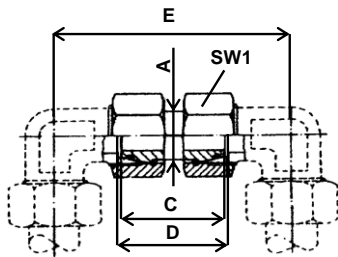

Reihe	PN	A	C	D	E	SW1
L	315	6	34,0	36,0	64,0	17
		8	34,0	36,0	64,0	17
		10	36,0	37,0	67,0	19
		12	36,0	37,0	71,0	22
		15	39,0	40,0	82,0	27
		18	40,5	42,5	89,5	32
	160	22	45,0	47,0	102,0	36
		28	47,0	49,0	110,0	46
		35	53,0	58,0	127,0	50
		42	53,0	59,0	139,0	60
S	630	6	37,0	39,0	71,0	17
		8	37,0	39,0	73,0	19
		10	41,0	43,0	78,0	22
		12	42,0	44,0	87,0	24
		14	45,0	48,0	92,0	27
	400	16	46,0	50,0	99,0	30
		20	55,0	60,0	113,0	36
		25	58,0	66,0	126,0	46
		30	62,0	73,0	144,0	50
	315	38	67,0	83,0	165,0	60

Winkel-Schwenkverschraubung mit zylindrischem Whitworth-Rohrgewinde

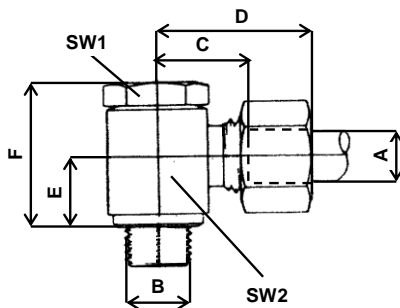

Reihe	PN	A	B	C	D	E	F	SW1	SW2	
LL	100	4	G 1/8 A	16,0	25,5	10,0	21,0	14	14	
		6	G 1/8 A	14,5	26,0	10,0	21,0	14	14	
		8	G 1/8 A	14,5	26,0	10,0	21,0	14	14	
L	250	6	G 1/8 A	13,0	27,5	10,0	21,0	14	14	
		6	G 1/4 A	15,0	29,5	13,5	23,0	19	19	
		8	G 1/4 A	14,0	28,5	13,5	27,0	19	19	
		10	G 1/4 A	15,0	29,5	13,5	27,0	19	19	
		12	G 1/4 A	15,0	29,5	15,5	30,0	19	22	
		12	G 3/8 A	17,5	32,0	16,0	32,5	22	24	
		15	G 1/2 A	21,0	36,0	19,5	43,0	27	30	
	18	G 1/2 A	20,5	36,5	21,5	43,0	27	30		
	100	22	G 3/4 A	27,0	43,0	24,0	48,0	32	36	
		28	G 1 A	31,5	48,0	30,5	59,0	41	46	
		35	G 1 1/4 A	35,5	57,0	35,5	70,0	50	55	
		42	G 1 1/2 A	40,0	62,5	40,5	80,0	60	65	
		S	400	6	G 1/4 A	16,0	30,5	13,5	27,0	19
8				G 1/4 A	16,0	30,5	13,5	27,0	19	19
10	G 3/8 A			18,0	34,0	16,0	32,5	22	24	
12	G 3/8 A			18,0	34,0	16,0	32,5	22	24	
14	G 1/2 A			22,0	39,5	19,5	41,0	27	30	
16	G 1/2 A			21,5	39,5	21,5	43,0	27	30	
20	G 3/8 A			26,0	47,5	24,0	48,0	32	36	
250	25	G 1 A	31,0	55,0	30,5	59,0	41	46		
	30	G 1 1/4 A	36,5	63,0	35,5	70,0	50	55		
	38	G 1 1/2 A	41,0	71,5	40,5	80,0	60	65		

Winkel-Schwenkverschraubung mit zylindrischem metrischem Gewinde

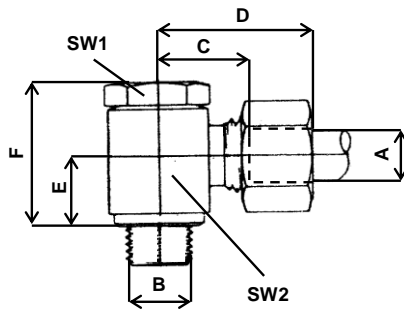

Reihe	PN	A	B	C	D	E	F	SW1	SW2
LL	100	4	M 8x1	13,0	22,5	8,0	17,0	12	12
		6	M 10x1	14,5	26,0	10,0	21,0	14	14
		8	M 10x1	14,5	26,0	10,0	21,0	14	14
L	250	6	M 10x1	13,0	27,5	10,0	21,0	14	14
		8	M 12x1,5	14,0	28,5	13,5	27,0	19	19
		10	M 14x1,5	15,0	29,5	13,5	27,0	19	19
		12	M 16x1,5	17,5	32,0	16,0	32,5	22	24
		12	M 18x1,5	20,0	34,5	18,5	36,0	22	24
		15	M 18x1,5	20,0	35,0	18,5	37,0	24	27
	100	18	M 22x1,5	20,5	36,5	21,5	43,0	27	30
		22	M 26x1,5	27,0	43,0	24,0	48,0	32	36
		28	M 33x2	31,5	48,0	30,5	59,0	41	46
		35	M 42x2	35,5	57,0	35,5	70,0	50	55
S	400	42	M 48x2	40,0	62,5	40,0	80,0	60	65
		6	M 12x1,5	16,0	30,5	13,5	27,0	19	19
		8	M 14x1,5	16,0	30,5	13,5	27,0	19	19
		10	M 16x1,5	18,0	34,0	16,0	32,5	22	24
		12	M 18x1,5	19,5	35,5	18,5	37,0	24	27
		14	M 20x1,5	22,0	39,5	19,5	41,0	27	30
	250	16	M 22x1,5	21,5	39,5	21,5	43,0	27	30
		20	M 27x1,5	26,0	47,5	24,0	48,0	32	36
		25	M 33x2	31,0	55,0	30,5	59,0	41	46
		30	M 42x2	36,5	63,0	35,5	70,0	50	55
38	M 48x2	41,0	71,5	40,5	80,0	60	65		

T - Schwenkverschraubung mit zylindrischem Whitworth-Rohrgewinde

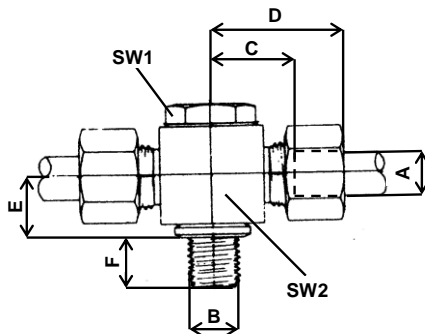

Reihe	PN	A	B	C	D	E	F	SW1	SW2
LL	100	4	G 1/8 A	16,0	25,5	10,0	8	14	14
		6	G 1/8 A	14,5	26,0	10,0	8	14	14
		8	G 1/8 A	14,5	26,0	10,0	8	14	14
L	250	6	G 1/8 A	13,0	27,5	10,0	8	14	14
		6	G 1/4 A	15,0	29,5	13,5	10	19	19
		8	G 1/4 A	14,0	28,5	13,5	10	19	19
		10	G 1/4 A	15,0	29,5	13,5	10	19	19
		12	G 1/4 A	15,0	29,5	15,5	10	22	19
		12	G 3/8 A	17,5	32,0	16,0	10	24	22
	100	15	G 1/2 A	21,0	36,0	19,5	14	30	27
		18	G 1/2 A	20,5	36,5	21,5	12	30	27
		22	G 3/4 A	27,0	43,0	24,0	16	36	32
		28	G 1 A	31,5	48,0	30,5	18	46	41
S	400	35	G 1 1/4 A	35,5	57,0	35,5	20	55	50
		42	G 1 1/2 A	40,0	62,5	40,5	22	65	60
		6	G 1/4 A	16,0	30,5	13,5	10	19	19
		8	G 1/4 A	16,0	30,5	13,5	10	19	19
		10	G 3/8 A	18,0	34,0	16,0	10	24	22
		12	G 3/8 A	18,0	34,0	16,0	10	24	22
	250	14	G 1/2 A	22,0	39,5	19,5	12	30	27
		16	G 1/2 A	21,5	39,5	21,5	12	30	27
		20	G 3/8 A	26,0	47,5	24,0	16	36	32
		25	G 1 A	31,0	55,0	30,5	18	46	41
30	G 1 1/4 A	36,5	63,0	35,5	20	55	50		
	38	G 1 1/2 A	41,0	71,5	40,5	22	65	60	

T - Schwenkverschraubung mit zylindrischem metrischem Gewinde

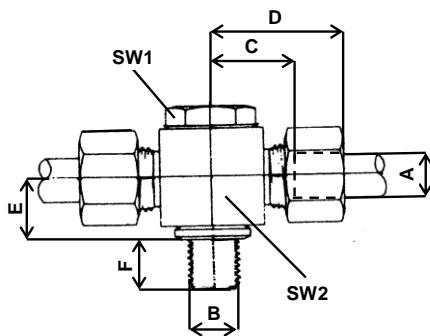

Reihe	PN	A	B	C	D	E	F	SW1	SW2
LL	100	4	M 8x1	16,0	25,5	10,0	8	14	14
		6	M 10x1	14,5	26,0	10,0	8	14	14
		8	M 10x1	14,5	26,0	10,0	8	14	14
L	250	6	M 10x1	15,0	29,5	13,5	10	19	19
		8	M 12x1,5	14,0	28,5	13,5	10	19	19
		10	M 14x1,5	15,0	29,5	13,5	10	19	19
		12	M 16x1,5	15,0	29,5	15,5	10	22	19
		12	M 18x1,5	17,5	32,0	16,0	10	24	22
		15	M 18x1,5	21,0	36,0	19,5	14	30	27
	100	18	M 22x1,5	20,5	36,5	21,5	12	30	27
		22	M 26x1,5	27,0	43,0	24,0	16	36	32
		28	M 33x2	31,5	48,0	30,5	18	46	41
		35	M 42x2	35,5	57,0	35,5	20	55	50
		42	M 48x2	40,0	62,5	40,5	22	65	60
		S	400	6	M 12x1,5	16,0	30,5	13,5	10
8	M 14x1,5			16,0	30,5	13,5	10	19	19
10	M 16x1,5			18,0	34,0	16,0	10	24	22
12	M 18x1,5			18,0	34,0	16,0	10	24	22
14	M 20x1,5			22,0	39,5	19,5	12	30	27
16	M 22x1,5			21,5	39,5	21,5	12	30	27
250	20		M 27x1,5	26,0	47,5	24,0	16	36	32
	25		M 33x2	31,0	55,0	30,5	18	46	41
	30		M 42x2	36,5	63,0	35,5	20	55	50
	38		M 48x2	41,0	71,5	40,5	22	65	60

Einstellbare Manometeranschlußstutzen mit Whitworth-Rohrgewinde

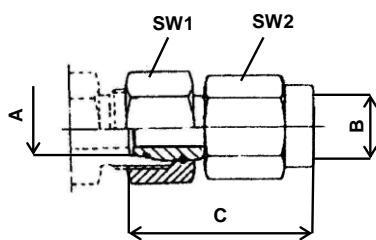

Reihe	PN	A	B	C	SW1	SW2
L	250	6	G 1/4	38,0	14	19
		8	G 1/4	38,0	17	19
		10	G 1/4	39,5	19	19
		12	G 1/4	40,5	22	19
S	630	6	G 1/2	48,0	17	27
		8	G 1/2	48,0	19	27
		10	G 1/2	50,0	22	27
		12	G 1/2	47,5	24	27

Einstellbare Manometeranschlußstutzen mit NPT Gewinde

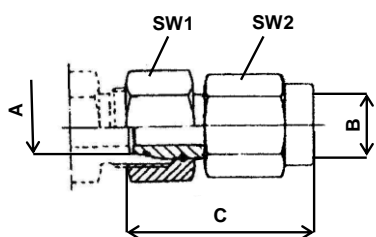

Reihe	PN	A	B	C	SW1	SW2
L	250	6	1/4 NPT	38,0	14	19
		8	1/4 NPT	38,0	17	19
		10	1/4 NPT	39,5	19	19
		12	1/4 NPT	40,5	22	19
S	630	6	1/2 NPT	45,0	17	27
		8	1/2 NPT	45,0	19	27
		10	1/2 NPT	47,0	22	27
		12	1/2 NPT	47,5	24	27

Manometeranschlußverschraubungen mit Whitworth-Rohrgewinde

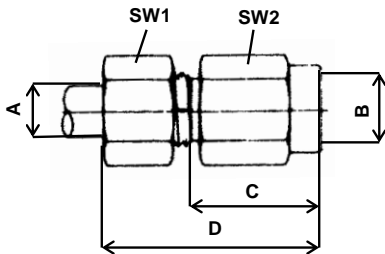

Reihe	PN	A	B	C	D	SW1	SW2
LL	100	4	G 1/4	23,0	33	10	19
L	250	6	G 1/4	22,0	37	14	19
		8	G 1/4	22,0	37	17	19
		10	G 1/4	23,0	38	19	19
		12	G 1/4	23,0	38	22	19
S	630	12	G 1/2	30,0	44	22	27
		6	G 1/2	31,0	46	17	27
		8	G 1/2	31,0	46	19	27
		10	G 1/2	30,5	47	22	27
		12	G 1/2	30,5	47	24	27
		14	G 1/2	32,0	48	27	27

Manometeranschlußverschraubungen mit NPT Gewinde

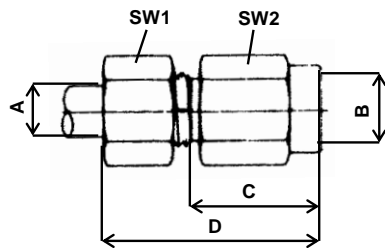

Reihe	PN	A	B	C	D	SW1	SW2
L	250	6	1/4 NPT	30	37,5	14	19
		8	1/4 NPT	30	37,5	17	19
		10	1/4 NPT	32	39,5	19	19
		12	1/4 NPT	32	39,5	22	19
		12	1/2 NPT	33	47,5	22	27
S	630	6	1/2 NPT	40	47,5	17	27
		8	1/2 NPT	40	47,5	19	27
		10	1/2 NPT	40	48,5	22	27
		12	1/2 NPT	40	48,5	24	27

Rückschlagventil

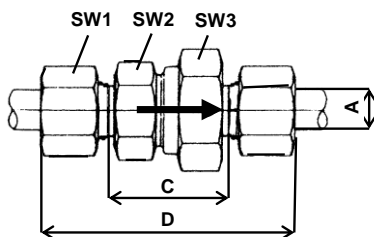

Reihe	PN	A	C	D	SW1	SW2	SW3
L	250	6	29,0	58,0	14	17	17
		8	30,0	59,0	17	17	19
		10	40,5	69,5	19	22	24
		12	43,5	72,5	22	27	30
		15	47,5	77,5	27	27	30
	160	18	51,5	83,5	32	36	36
		22	61,5	93,5	36	41	46
	100	28	71,5	104,5	41	50	55
		35	68,5	111,5	50	60	60
		42	83,0	128,0	60	80	90
S	400	6	34,5	63,5	17	19	19
		8	34,5	63,5	19	19	22
		10	40,5	72,5	22	24	27
		12	42,5	74,5	24	27	30
		14	47,5	82,5	27	27	32
		16	50,5	86,5	30	32	36
	250	20	54,5	97,5	36	41	46
		25	58,5	106,5	46	46	50
		30	69,5	122,5	50	55	60
		38	75,5	136,5	60	65	70

Rückschlagventil mit Innengewinde

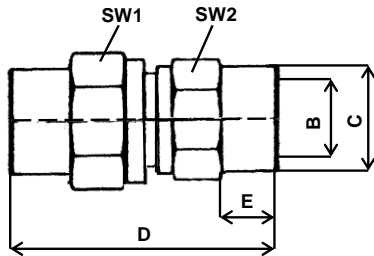

		B	C	D	E	SW1	SW2
400	G 1/8	19	42,5	8,0	19	19	
	G 1/4	19	51,0	12,0	19	19	
	G 3/8	24	60,0	12,0	24	27	
	G 1/2	32	72,0	15,0	32	36	
	G 3/4	41	84,0	16,5	41	46	
250	G 1	46	95,0	19,0	46	50	
	G 1 1/4	60	110,0	21,5	60	60	
	G 1 1/2	65	114,0	22,0	65	70	

Rückschlagventil mit Einschraubzapfen

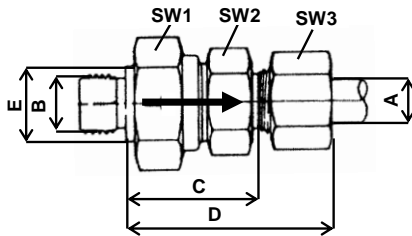

Reihe	PN	A	B	C	D	E	SW1	SW2	SW3
L	250	6	G 1/8 A	28,0	42,5	14	17	17	14
		8	G 1/4 A	30,0	42,5	19	19	19	17
		10	G 1/4 A	35,5	50,0	19	22	24	19
		12	G 3/8 A	42,5	57,0	22	27	30	22
		15	G 1/2 A	45,5	60,5	27	27	30	27
		18	G 1/2 A	49,0	66,0	27	36	36	32
	100	22	G 3/4 A	55,0	71,0	32	41	46	36
		28	G 1 A	65,0	81,5	40	50	55	41
		35	G 1 1/4 A	69,0	90,5	50	60	60	50
		42	G 1 1/2 A	81,0	103,5	55	80	90	60
S	400	6	G 1/4 A	31,5	46,0	19	19	19	17
		8	G 1/4 A	31,5	46,0	19	19	22	19
		10	G 3/8 A	38,0	54,0	22	24	27	22
		12	G 3/8 A	41,0	57,0	22	27	30	24
		14	G 1/2 A	44,5	62,0	27	27	32	27
		16	G 1/2 A	48,0	65,0	27	32	36	30
		20	G 3/4 A	52,0	73,5	32	41	46	36
	250	25	G 1 A	54,5	78,5	40	46	50	46
		30	G 1 1/4 A	64,0	90,5	50	55	60	50
		38	G 1 1/2 A	69,5	100,0	55	65	70	60

Rückschlagventil mit Einschraubzapfen

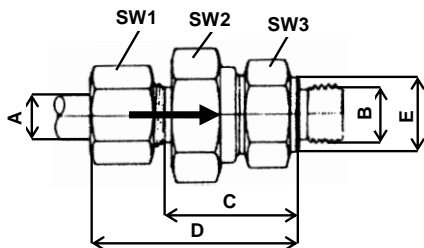

Reihe	PN	A	B	C	D	E	SW1	SW2	SW3
L	250	6	G 1/8 A	26,5	41,0	14	17	17	14
		8	G 1/4 A	28,5	43,0	19	19	19	17
		10	G 1/4 A	38,5	53,0	19	22	24	19
		12	G 3/8 A	40,5	55,0	22	27	30	22
		15	G 1/2 A	42,5	57,5	27	27	30	27
	160	18	G 1/2 A	48,0	69,0	27	36	36	32
		22	G 3/4 A	56,0	72,0	32	41	46	36
		28	G 1 A	64,0	80,5	40	50	55	41
	100	35	G 1 1/4 A	64,0	80,5	50	60	60	50
		42	G 1 1/2 A	81,0	105,5	55	80	90	60
S		400	6	G 1/4 A	31,5	46,0	19	19	19
	8		G 1/4 A	31,5	46,0	19	19	22	19
	10		G 3/8 A	38,0	54,0	22	24	27	22
	12		G 3/8 A	41,0	57,0	22	27	30	24
	14		G 1/2 A	43,5	61,0	27	27	32	27
	16		G 1/2 A	46,0	64,0	27	32	36	30
	20		G 3/4 A	50,0	71,0	32	41	46	36
250	25	G 1 A	54,5	78,5	40	46	50	46	
	30	G 1 1/4 A	64,0	90,5	50	55	60	50	
	38	G 1 1/2 A	71,5	102,0	55	65	70	60	

Meßanschluß

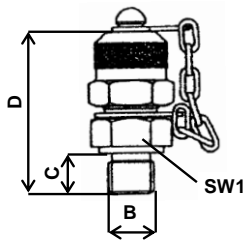

PN	B	C	D	SW1
250	M 8x1	8	36	17
400	M 10x1	10	38	17
630	G 1/4	12	36	19
400	1/8 NPT	9	34	17
630	1/4 NPT	14	34	17

Meßanschluß für 24° Konen

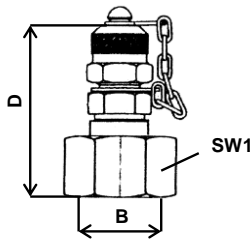

PN	A	B	D	SW1
250	6	M 12x1,5	47	14
	8	M 14x1,5	47	17
	10	M 16x1,5	48	19
	12	M 18x1,5	48	22
630	6	M 14x1,5	47	17
	8	M 16x1,5	48	19
	10	M 18x1,5	48	22
	12	M 20x1,5	50	24

Meßventile

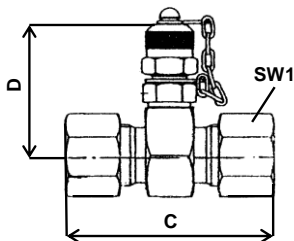

Reihe	PN	A	B	C	D	SW1
L	250	6	M 12x1,5	52,5	49	14
		8	M 14x1,5	52,5	49	17
		10	M 16x1,5	54,5	49	19
		12	M 18x1,5	54,5	49	22
		15	M 22x1,5	57,5	52	27
	160	18	M 26x1,5	58,5	53	32
		22	M 30x2	62,5	55	36
	100	28	M 36x2	63,4	57	41
		35	M 45x2	71,5	60	50
		42	M 52x2	72,5	64	60
S	400	6	M 14x1,5	56,5	49	17
		8	M 16x1,5	56,5	49	19
		10	M 18x1,5	58,5	49	22
		12	M 20x1,5	58,5	49	2
		14	M 22x1,5	64,5	50	27
		16	M 24x1,5	64,5	52	30
		20	M 30x2	71,5	55	36
		25	M 36x2	77,5	57	46
	250	30	M 42x2	83,5	60	50
		38	M 52x2	93,0	64	60

Verschlussverschraubung

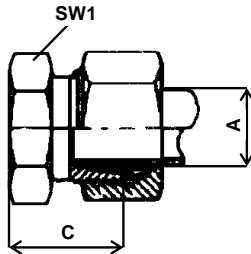

Reihe	PN	A	C	SW1
LL	100	4	12	9
		6	12	11
		8	14	12
L	250	6	17	12
		8	17	14
		10	17	17
		12	17	19
		15	18	24
	160	18	19	27
		22	21	32
	100	28	22	41
		35	25	46
		42	27	55
S	630	6	18	14
		8	18	17
		10	20	19
		12	20	22
		14	24	24
	400	16	24	27
		20	28	32
		25	32	41
	250	30	34	46
		38	39	55

Verschlusschrauben / Innensechskant mit Dichtring

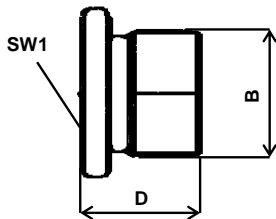

	B	C	SW1
M 10x1,5	12,0	5	
M 12x1,5	17,0	6	
M 14x1,5	17,0	6	
M 16x1,5	17,0	8	
M 18x1,5	17,0	8	
M 20x1,5	19,0	10	
M 22x1,5	19,0	10	
M 26x1,5	21,0	12	
M 27x2	21,0	12	
M 33x2	22,5	17	
M 42x2	22,5	22	
M 48x2	22,5	24	

	B	C	SW1
G 1/8 A	12,0	5	
G 1/4 A	17,0	6	
G 3/8 A	17,0	8	
G 1/2 A	19,0	10	
G 3/4 A	21,0	12	
G 1 A	22,5	17	
G 1 1/4 A	22,5	22	
G 1 1/2 A	22,5	24	

Verschlusschrauben / Innensechskant mit Dichtkante

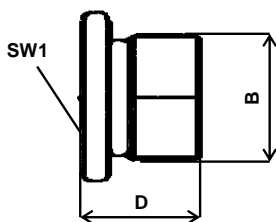

	B	C	SW1
M 10x1,5	12,0	5	
M 12x1,5	17,0	6	
M 14x1,5	17,0	6	
M 16x1,5	17,0	8	
M 18x1,5	17,0	8	
M 20x1,5	19,0	10	
M 22x1,5	19,0	10	
M 26x1,5	21,0	12	
M 27x2	21,0	12	
M 33x2	22,5	17	
M 42x2	22,5	22	
M 48x2	22,5	24	

	B	C	SW1
G 1/8 A	12,0	5	
G 1/4 A	17,0	6	
G 3/8 A	17,0	8	
G 1/2 A	19,0	10	
G 3/4 A	21,0	12	
G 1 A	22,5	17	
G 1 1/4 A	22,5	22	
G 1 1/2 A	22,5	24	

Verschlussstopfen mit O-Ring

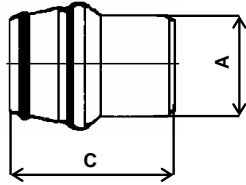

Reihe	PN	A	C
LL	100	4	17,0
		6	17,0
		8	17,0
L	250	6	17,5
		8	18,5
		10	19,0
		12	19,0
		15	19,5
	160	18	20,0
		22	20,5
	100	28	21,5
		35	23,5
		42	23,5
S	630	6	17,0
		8	18,5
		10	19,0
		12	19,0
		14	20,0
	400	16	20,0
		20	24,0
		25	25,0
	250	30	26,5
		38	28,5

Verschlussstopfen

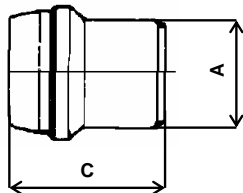

Reihe	PN	A	C
LL	100	4	13,5
		6	15,0
		8	15,0
L	250	6	17,0
		8	17,0
		10	20,0
		12	21,0
		15	20,0
	160	18	21,0
		22	23,0
	100	28	23,0
		35	29,0
		42	30,0
S	630	6	17,0
		8	17,0
		10	20,0
		12	21,0
		14	23,0
	400	16	24,0
		20	28,0
		25	31,0
	250	30	34,0
		38	38,0

Schweißnippel mit O-Ring

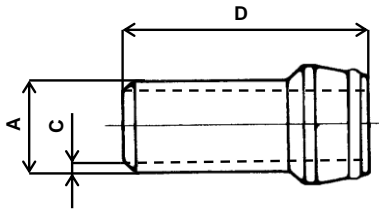

A	C	D	O-Ring
6	1,5	31,0	4 x 1,5
8	1,5	31,0	6 x 1,5
8	2,0	31,0	6 x 1,5
10	2,0	32,5	7,5 x 1,5
12	1,5	32,5	9 x 1,5
12	2,0	32,5	9 x 1,5
12	2,5	32,5	9 x 1,5
14	2,0	40,0	10 x 1,5
14	3,0	40,0	10 x 1,5
15	2,0	36,0	12 x 1,5
15	2,5	36,0	12 x 1,5
16	2,5	39,0	12 x 1,5
16	2,0	39,0	12 x 1,5
16	3,0	39,0	12 x 1,5
18	2,5	36,0	15 x 1,5
20	2,0	44,5	16,3 x 1,5
20	2,5	44,5	16,3 x 1,5
20	3,0	44,5	16,3 x 1,5
20	3,5	44,5	16,3 x 1,5
20	4,0	44,5	16,3 x 1,5
22	2,5	38,5	20 x 1,5
25	3,0	49,5	20,3 x 1,5
25	3,5	49,5	20,3 x 1,5
25	4,0	49,5	20,3 x 1,5
25	5,0	49,5	20,3 x 1,5
28	2,5	41,5	26 x 1,5
28	3,0	41,5	26 x 1,5
30	3,0	52,0	25,3 x 1,5
30	4,0	52,0	25,3 x 1,5
30	5,0	52,0	25,3 x 1,5
30	6,0	52,0	25,3 x 1,5
35	3,5	47,0	32 x 1,5
35	4,0	47,0	32 x 1,5
38	3,0	56,5	33,3 x 1,5
38	4,0	56,5	33,3 x 1,5
38	5,0	56,5	33,3 x 1,5
38	6,0	56,5	33,3 x 1,5
38	7,0	56,5	33,3 x 1,5
38	8,0	56,5	33,3 x 1,5
42	3,0	47,0	38 x 1,5
42	4,0	47,0	38 x 1,5

Überwurfmutter

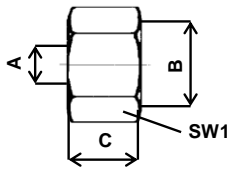

Reihe	PN	A	B	C	SW1	
LL	100	4	M 8x1	11,0	10	
		6	M 10x1	11,5	12	
		8	M 12x1	12,0	14	
L	250	6	M 12x1,5	14,5	14	
		8	M 14x1,5	14,5	17	
		10	M 16x1,5	15,5	19	
	160	12	M 18x1,5	15,5	22	
		15	M 22x1,5	17,0	27	
		18	M 26x1,5	18,0	32	
		22	M 30x2	20,0	36	
	100	28	M 36x2	21,0	41	
		35	M 45x2	24,0	50	
		42	M 52x2	24,0	60	
	S	630	6	M 14x1,5	16,5	17
			8	M 16x1,5	16,5	19
10			M 18x1,5	17,5	22	
12			M 20x1,5	17,5	24	
14			M 22x1,5	20,5	27	
400		16	M 24x1,5	20,5	30	
		20	M 30x2	24,0	36	
		25	M 36x2	27,0	46	
250		30	M 42x2	29,0	50	
		38	M 52x2	32,5	60	

Schneidring

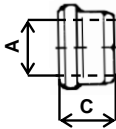

Reihe	PN	A	C	
LL	100	4	6,0	
		6	7,0	
		8	7,0	
L	250	6	9,5	
		8	9,5	
		10	10,0	
	160	12	10,0	
		15	10,0	
		18	10,0	
		22	10,5	
	100	28	10,5	
		35	13,0	
		42	13,5	
	S	630	6	9,5
			8	9,5
10			10,0	
12			10,0	
14			10,0	
400		16	10,5	
		20	12,5	
		25	12,5	
250		30	13,0	
		38	13,5	

Gegenmutter

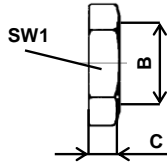

Reihe		A	B	C	SW1
L		6	M 12x1,5	6	17
		8	M 14x1,5	6	19
		10	M 16x1,5	6	22
		12	M 18x1,5	6	24
		15	M 22x1,5	7	30
		18	M 26x1,5	8	36
		22	M 30x2	8	41
		28	M 36x2	9	46
		35	M 45x2	9	55
	42	M 52x2	10	65	
S		6	M 14x1,5	6	19
		8	M 16x1,5	6	22
		10	M 18x1,5	6	24
		12	M 20x1,5	7	27
		14	M 22x1,5	7	30
		16	M 24x1,5	7	32
		20	M 30x2	8	41
		25	M 36x2	9	46
		30	M 42x2	9	50
	38	M 52x2	10	65	

Verstärkungshülse

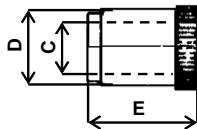

A	C	D	E
4	2,5	3,8	15,5
5	3,5	4,8	15,5
6	4,5	5,8	15,5
7	5,5	6,8	17,0
8	6,5	7,8	17,0
9	7,5	8,8	17,0
10	8,5	9,8	17,0
11	9,5	10,8	18,0
12	10,0	11,8	18,0
13	11,5	12,8	18,0
14	12,0	13,8	18,0
15	13,0	14,8	18,0
16	14,0	15,8	22,0
17	15,0	16,8	22,0
18	16,0	17,8	22,0
19	17,0	18,8	18,0
20	18,0	19,8	18,0
22	20,0	21,8	24,0
24	22,0	23,8	18,0
25	23,0	24,8	18,0
31	28,5	30,8	18,0
33	30,0	32,8	23,0
38	35,5	37,8	24,0

Dichtring FKM

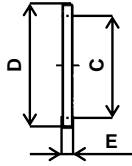

	für IG	C	D	E
M	8x1	6,4	9,9	0,8
M	10x1	8,4	12,0	0,8
M	12x1,5	9,7	14,5	1,2
M	14x1,5	11,7	16,6	1,2
M	16x1,5	13,7	18,6	1,2
M	18x1,5	15,7	21,0	1,2
M	22x1,5	17,5	22,6	1,2
M	26x1,5	19,7	24,4	1,2
M	27x1,5	23,7	29,3	1,2
M	33x2	24,0	29,3	1,6
M	42x2	30,0	35,8	1,6
M	48x2	39,0	45,8	1,6
M	52x2	45,0	50,8	1,6
G	1/8 A	8,3	12,0	0,8
G	1/4 A	11,2	16,6	1,2
G	3/8 A	14,7	19,0	1,2
G	1/2 A	18,4	24,0	1,2
G	3/4 A	23,9	29,3	1,2
G	1 A	29,9	35,8	1,6
G	1 1/4 A	38,6	45,9	1,6
G	1 1/2 A	44,5	50,8	1,6

Dichtkantenring

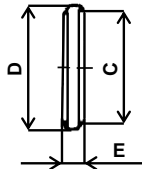

	für AG	C	D	E
G	1/8 A	9,8	14	4
G	1/4 A	13,3	18	3
G	3/8 A	16,8	22	3
G	1/2 A	21,1	26	4
G	3/4 A	27,1	32	4
G	1 A	33,3	39	6
G	1 1/4 A	42,1	49	6
G	1 1/2 A	48,1	55	6
M	10x1	10,0	14	4
M	12x1,5	12,1	17	3
M	14x1,5	14,1	19	3
M	16x1,5	16,1	21	3
M	18x1,5	18,1	23	4
M	20x1,5	20,1	25	4
M	22x1,5	22,1	27	4
M	26x1,5	26,1	31	4
M	27x1,5	27,1	32	4
M	33x2	33,1	39	5
M	42x2	42,1	49	6
M	48x2	48,1	55	6

O - Ring FKM

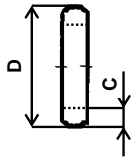

für Schweiß- nippel	C	D
6	1,5	4,0
8	1,5	6,0
10	1,5	7,5
12	1,5	9,0
14	2,0	10,0
15	2,0	12,0
16	2,0	12,0
18	2,5	15,0
20	2,4	16,3
22	2,0	20,0
25	2,4	20,3
28	2,0	26,0
30	2,4	25,3
35	2,5	32,0
38	2,4	33,3
42	2,5	38,0